

MAP to Uof O Field Station. The exact location of the field station is marked "FS" on the map below.

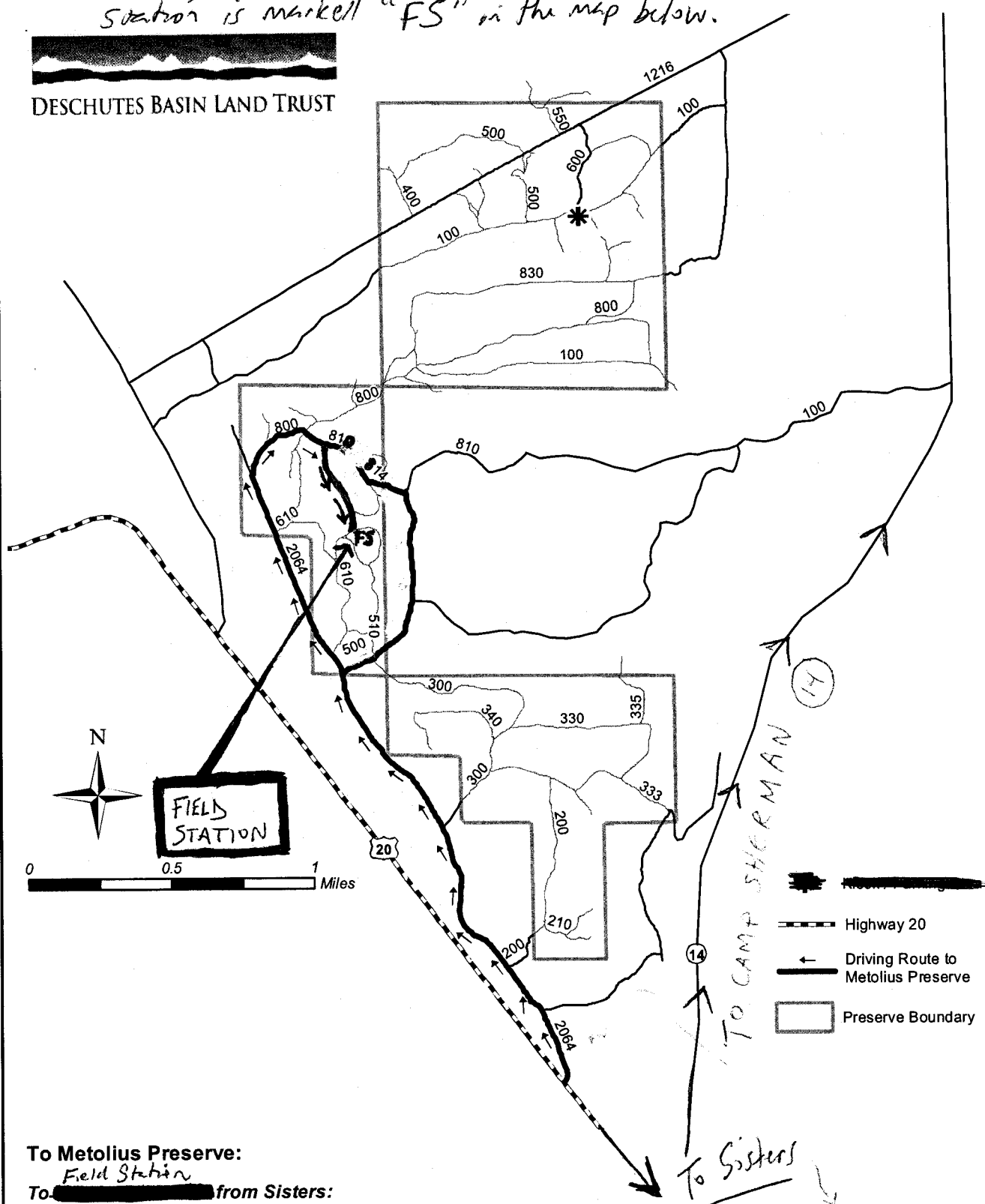

To Metolius Preserve:

Field Station
 To [redacted] from Sisters:

Drive 10.6 miles west of Sisters on Highway 20/126. Take a right on Forest Service Road 2064. This is the first right turn after the Camp Sherman/Metolius River turnoff. Travel 2.6 miles on Road 2064 (rough cinder road). Turn right on Road 800 and continue for 0.25 miles. Turn right on Road 810 and continue for [redacted] a few hundred yards. Turn right onto road 811. Stay to the right. The field station has a cedar shed and picnic tables on the left.

c:\gis\lav_projects\ld\bl\metolius_preserve\metolius_dir.ec.mxd

From Eugene: The easiest way to find the turnoff to Forest Service Road 2064 is to get to the Camp Sherman/Metolius turnoff (14), then TURN AROUND and backtrack for less than a mile to road 2064. Then follow directions above.

MAPQUEST.

★ Camp Sherman, OR US

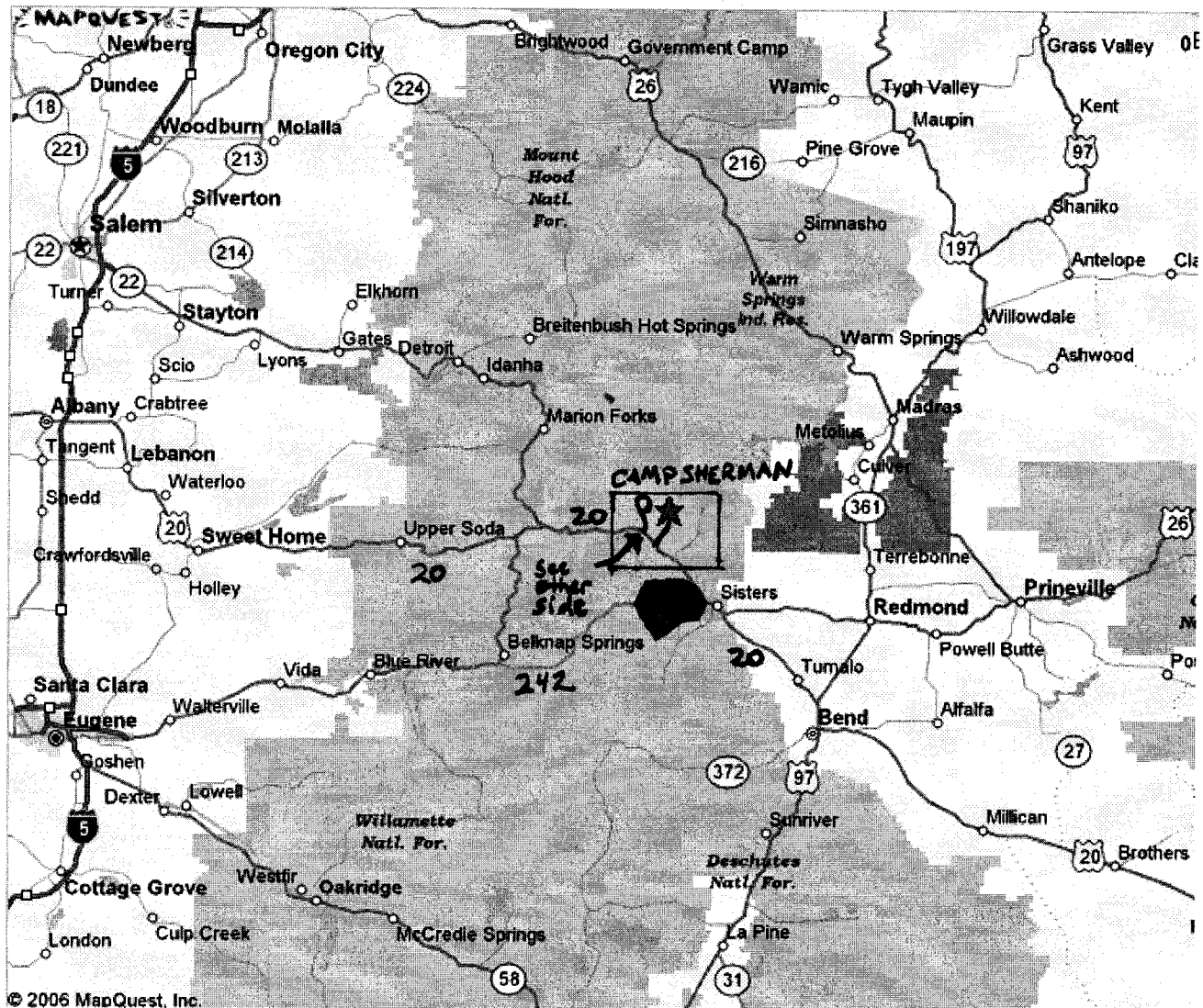

All rights reserved. Use Subject to License/Copyright

This map is informational only. No representation is made or warranty given as to its content. User assumes all risk of use. MapQuest and its suppliers assume no responsibility for any loss or delay resulting from such use.

THIS MAP SHOWS CAMP SHERMAN. THE ROAD LEADING FROM 20 TO CAMP SHERMAN IS (14). FOREST SERVICE ROAD 2064 IS JUST TO THE WEST OF (14). See other side.