

STEERING COMMITTEE

MCC, SU'S, WOMEN'S CENTER - OK

↳ INCLUDE SWAT

WALLS BTWN UNIONS & RETAIL - ABILITY TO CLOSE WINDOWS FROM SU'S TO ATRIUM
CONVENIENT TO BIKE/WALK THRU AREA.

MENS / NONTRAD CENTER'S MORE DISTINCT SPACES

GOAL: ATRIUM FUNCTION AS DAYLIGHTING FOR NORTH OFFICES
STOREFRONT INTERIOR ON ATRIUM/HEARTH IS STILL LATE-NITE/24

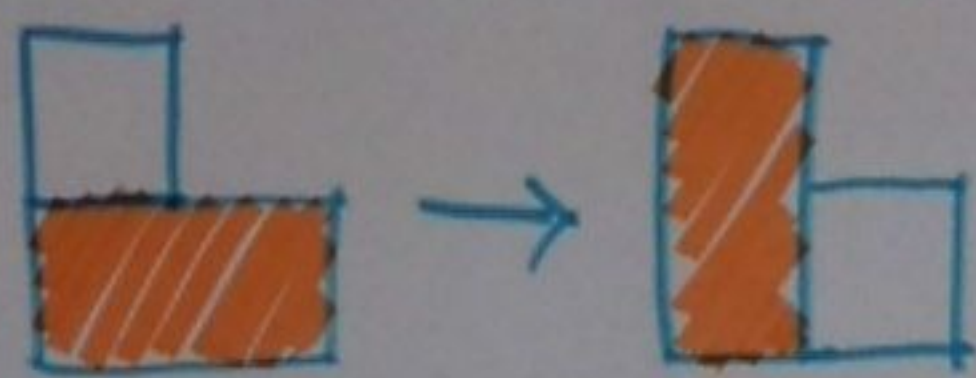

ASUO & WOMEN'S CENTER

MCC & SU'S WALLS AROUND MCC & HALLWAY - REMOVE?

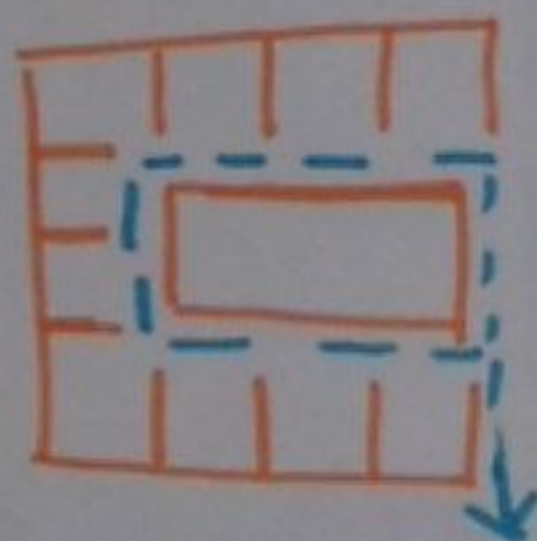

USE FURNITURE, KITCHENETTE IN MCC AS SPACE DIVIDERS TO SU'S.

PUB MOVED FROM FISHBOWL TO LOWER LEVEL. ✓

↳ ICONIC LOCATION

ACCESSIBLE TO ALL

CONCERT HALL:

\$\$? VS. TUITION ↑. NO STUDENT FEES FOR C.H. VOLUME & BACK OF HOUSE.

DONATIONS TIED TO CONCERT HALL? YES

NOT STUDENT PROGRAM SPACE