

Project Number 11045
Purpose Subject Area Committee Meetings
Location Gumwood Room
Start Time 4:30 PM

Conference Report

Student Leadership Group #3

Multi Cultural Center (MCC)

Student Unions:
Black Student Union
Black Women of Achievement
Vietnamese Student Union
Jewish Student Union
Arab Student Union
Native American Student Union
Asian –Pacific American Student Union
LGBTQA
MEChA
Coalition against Environmental Racism

01 THOSE PRESENT

MCC and Student Unions

John Michael Lahtiner (LGBTQA), Ky Kubitz (LGBTQA), Francisco Morales (MEChA), Hussein Abu-Hamkeh (Arab Student Union), Michael King (MCC), Alex Sylvester (LGBTQA), Steve Morozumi (MCC)

EMU Board

Jo Niehaus

Oregon, Campus Planning and Real Estate

Martina Bill, Fred Tepfer

EMU User Group

Gregg Lobisser, Dan Geiger, Mandy Chong, Wendy Polhemus

AC Martin

Bob Murrin, Tammy Jow, Christopher King

SERA Architects

Eric Philps

02 DISCUSSION

- Jo Niehaus, EMU Board representative, provided the following accounting of those groups and their associated existing sizes, currently housed in the EMU/MCC/Student Union area.

ORGANIZATION/PROGRAM	ROOM	Existing Base	Notes
Multicultural Center	Suite 33	1462	Room Total
Black Student Union	25	176	
Native American Student Union	26	202	
Black Women of Achievement	27	133	shared
Vietnamese Student Association	27	133	shared
Jewish Student Union	28	167	
Asian-Pacific American Student Union	29	202	shared
Kultura Pilipinas	29	202	shared
MECHA	30	212	
LGBTQA	34	432	
Coalition Against Environmental Racism	Suite 33	?	space in MCC

Multi Cultural Center (MCC) Suite with Student Unions

- The current vision for the MCC and Student Unions are to be grouped in a dynamic suite that gives individual groups autonomy and privacy, yet lets them come together in a large, shared resource space, for meetings, conferences and lounging. The following diagrams illustrate the relationships of the Suite:

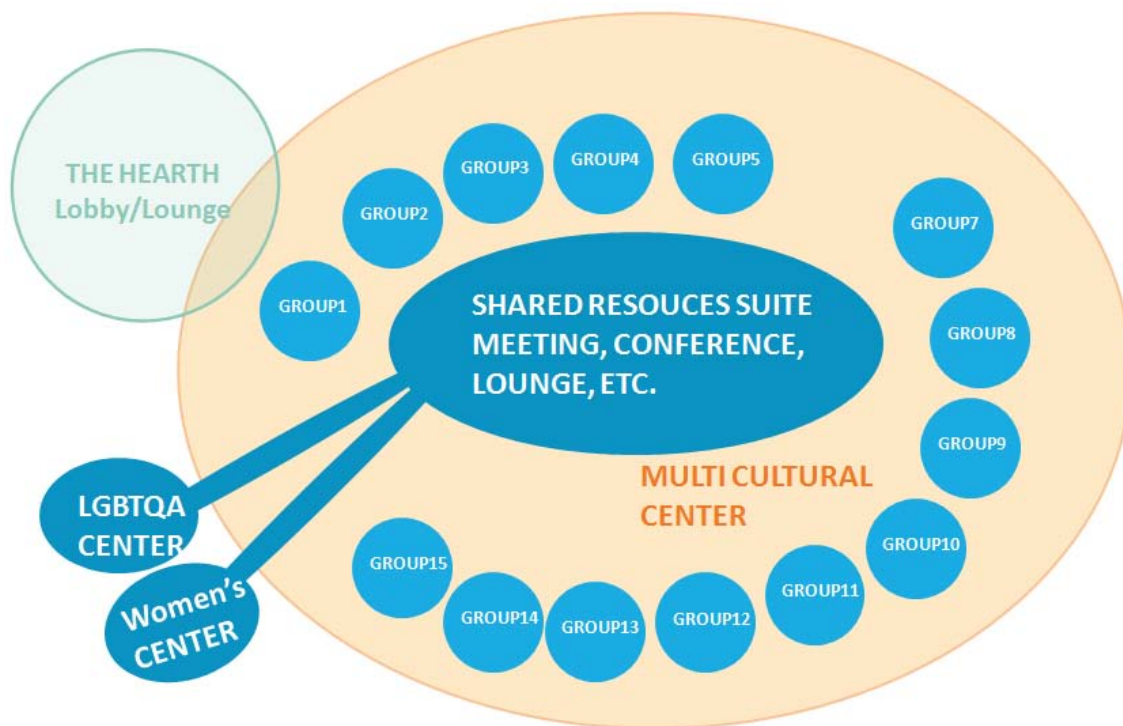

3. Scaled three-dimensional blocks to represent the program were also presented to illustrate the relative size of the program elements.

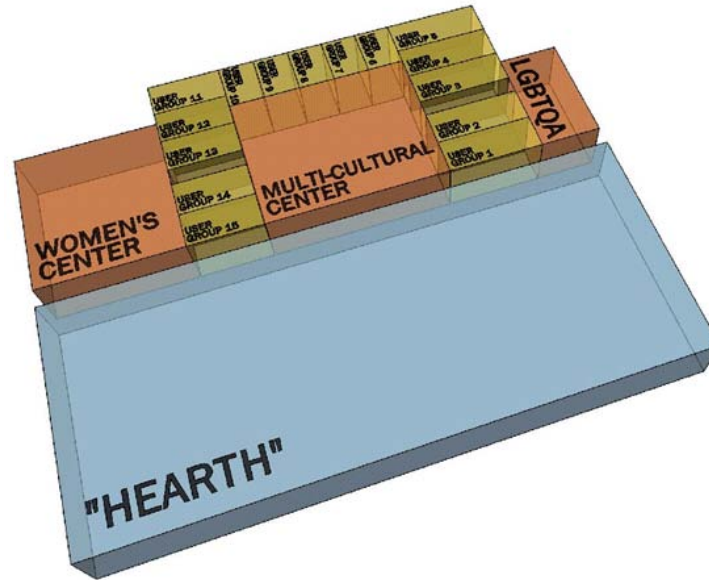

Multi Cultural Center (MCC)

4. The current program (version 7.2) was presented and revised below (to version 8.2) based upon discussion. No dedicated reception required, can be included within general common area.

Multi-Cultural Center	Quantity	Unit	NASF	GSF	
Reception	1	100	100	155	
Staff					
Director (enclosed office)	1	120	120	186	
Staff Work Stations	1	64	64	99	
Student Work Stations	4	36	144	223	
Collaborative Workspace/Resource Library (18) partitionable	1	400	400	620	
Common Area for the following:	1	550	550	853	
Lounge/seating					
Exhibit/display area/AV					
Kitchenette (back wall of common area)					
Student Computer stations	5	20	100	155	
Chair Storage	1	100	100	155	
Storage	2	36	72	112	
TOTAL			1,650	2,558	
Internal Circulation factor 25%			413		
Suite Total			2,063		
Multi Cultural Center Remote Storage	0	100	0	0	
Large Meeting Room (55 people)	0	1,200	0	0	Shared

5. Scaled three-dimensional blocks to represent the program were also presented.

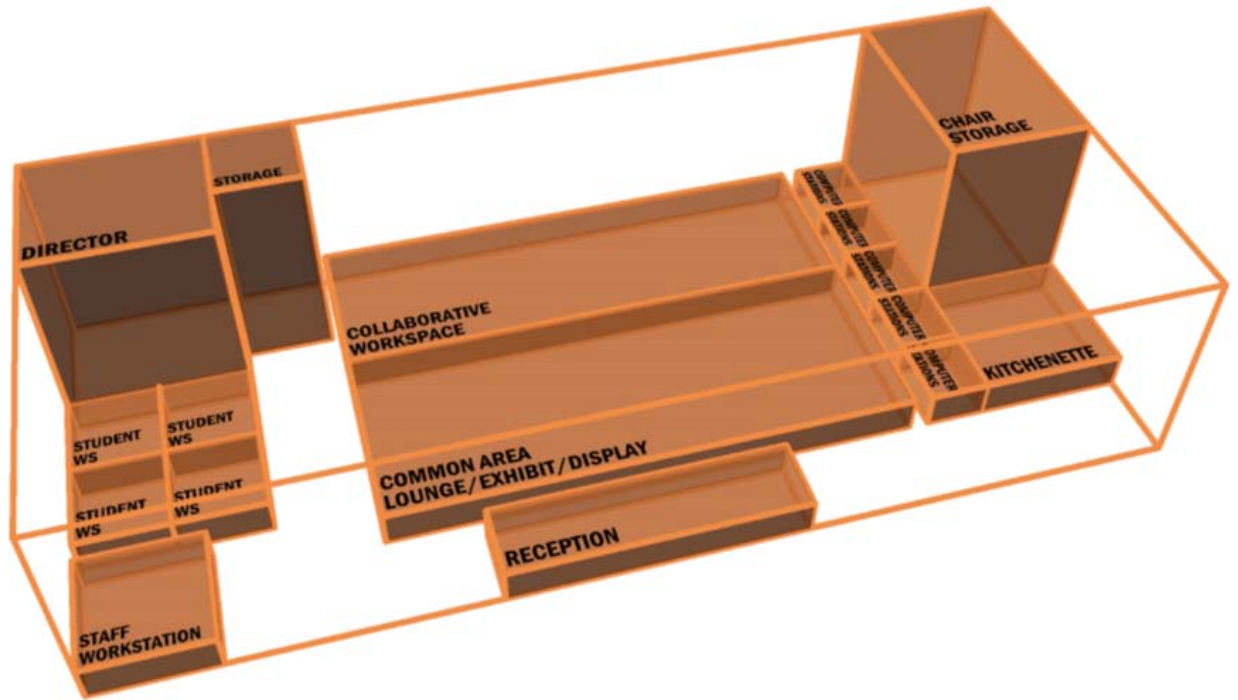

MCC

DIRECTOR
1 OFFICE @ 120 SF



STAFF WORKSTATION
1 WORKSTATION @ 64 SF



STUDENT WORKSTATIONS
4 WORKSTATIONS @ 36 SF



PRODUCTION COORDINATOR
5 WORKSTATIONS @ 20 SF



KITCHENETTE



MCC workstations

Student Unions:

- 6 The current program (version 7.2) was presented and revised below (to version 8.2) based upon discussion. Fifteen total Student Unions can be accommodated, with three different modules (5 each) of 300, 225 and 150 net square feet. There was discussion about keeping all Student Unions the same size. EMU Board preference would be to keep them all the same size for easy management (total area would be required to be the same); but Student Union representatives preference was to keep 3 different sizes. Decision: keep the program as is: 3 different sizes.

Student Unions	Quantity	Unit	NASF	GSF
Student Union Module 1 (Large)				
Student Work Stations	2	36	72	112
Student Work Stations	2	20	40	62
Lounge / Open Space	1	188	188	291
Each			300	465
Quantity of Module 1 Unions	5		1,500	2,325
Student Union Module 2 (Medium)				
Student Work Stations	4	20	80	124
Lounge / Open Space	1	145	145	225
Each			225	349
Quantity of Module 2 Unions	5		1,125	1,744
Student Union Module 3 (Small)				
Student Work Stations	2	20	40	62
Lounge / Open Space	1	110	110	171
Each			150	233
Quantity of Module 3 Unions	5		750	1,163
TOTAL Student Unions	15		3,375	5,231

7. Scaled three-dimensional blocks to represent the program were also presented.

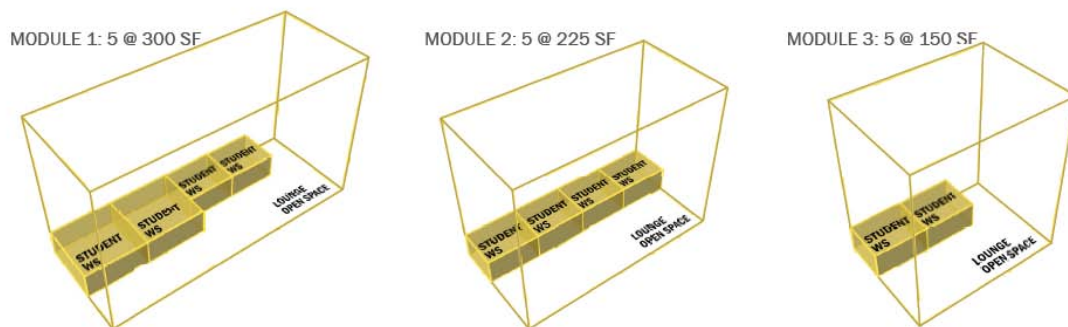

Student Unions

LGBTQA:

8. The current program (version 7.2) was presented and revised below (to version 8.2) based upon discussion.

LGBTQA	Quantity	Unit	NASF	GSF	
Staff Work Stations	1	64	64	99	
Student Work Stations	4	20	80	124	
Small work Room (5)	1	110	110	171	
Lounge Space/Reception (5 people)	1	110	110	171	
Storage	1	36	36	56	
TOTAL			400	620	
Internal Circulation factor 25%			100		
Suite Total			500		
Conference Room (5 people)	0	110	0	0	Shared

9. Scaled three-dimensional blocks to represent the program were also presented.
- LGBTQA asked that their space be as open as possible, removing partitions from small workroom and having workstations with the capability to be easily moved to allow maximum flexibility of their space.
 - They prefer to hold large meetings in this space. Student workstations that can fold down or tuck into walls during large meetings. Workstations that are just tables, not computer stations, giant crafting tables hung from walls with power. Not study oriented space in office. Seating and standing levels.
 - L-shaped staff station – sit behind desk but still see room or lead meetings from that position.

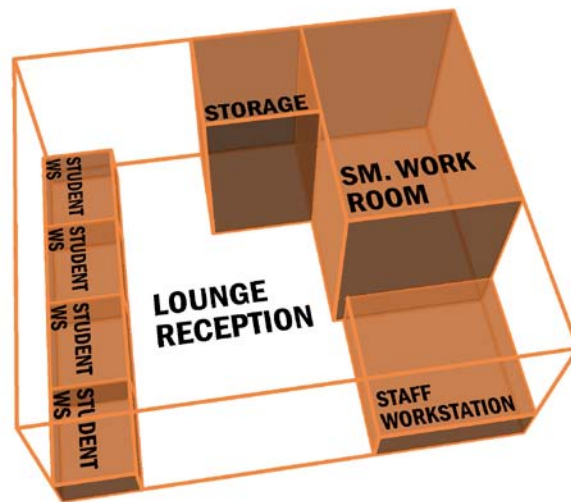

LGBTQA