

# FOOD SERVICE

①

"ACTIVITY GENERATOR"

FOOD AS MAGNET

EDGE OF CENTRAL "GRANT" SPACE

NEW PROGRAM ELEMENTS  
EG PUB

STAFFING  
SERVICE

MISSION - FULFILL NEEDS & WANTS OF  
COMMUNITY  
**SERVICE**

FEED NOURISH PROVIDE DESTINATION

NEXUS OF SOCIAL INTERACTION

REVENUE GENERATOR

VENUES - BUZZ + BREAK + UNION -

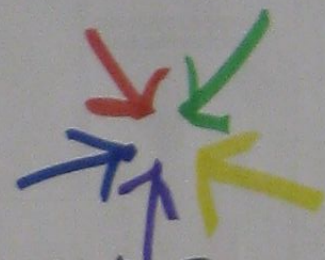

LOWER LEVEL

SELF-OP

BREAK - MTGS, POOL

UNION MARKET - STEPCHILD OF FOOD SERV.

→ LONGEST HOURS, INCLUDING BEYOND  
FOOD PREP'D AT CENTRAL PROFIT POINT

DELIVERIES VIA LOADING DOCK &  
TRASH & COMPOST & RECYCLE FREIGHT ELEV.  
ELEV. TO DOCK  
2X/DAY

LOWER LEVEL

BUZZ CAFE

BREAK - BILLIARDS  
+ CALL CENTER

UNION MARKET  
CONV. STORE

VENUES (CONTINUED)

VENUES (CONTINUED)

(2)

GROUND LEVEL:

FISHBOWL (SELF-OP)

MARKETPLACE

REV. 3-4  
SHARED

4 TENANT SPACES, 1 SHARED BY 4

EACH TENANT HAS (7 TENANTS TOTAL)

STORAGE & REFR.  
SPACE HAS HOOD

PITA PIT  
Q DOBEY  
WORLD FLAVORS  
SARA'S TAMALES

STRAINS

REV. 1

PANDA - SELF CONTAINED

REV. 2+

SUBWAY - NO HOOD

REV. 3-4

HOLT COW (LOCAL)

+ TBD VENDOR OR MARKETPLACE

W/ INDEPENDENT REF/FR.

SHARED SPRAGE  
DEDICATED STORAGE & FRIDGE DESIRABLE

SHARED DISH/POT ~~STORAGE~~ WASH

+ SUPPORT FOR 4 ESPRESSO BAR +  
PACKAGED ITEMS  
SATELLITES -

INCREASING

+ VENDING CONTRACT SUPPORT (~120)  
FOR WHOLE CAMPUS  
USE LOADING DOCK

BEST TO HAVE A HOOD IN EACH SPACE  
CATERING - FROM OFF-SITE (U. HOUSING)

3

KITCHEN - HAS DEDICATED STORAGE

LOADING DOCK (4x) REF / FREEZER CONGESTED

CATERING - NEEDS SPACE FOR STORAGE · PLATING · RERRING.

NO CATERING KITCHEN CURRENTLY DESIRABLE?  
COMBINE W/ CULTURAL STUDENT GROUP COOKING?

DESIRE:

DESIGN FOR ZERO OR MINIMAL INTRUSION OF CATERING IN PUBLIC SPACE

IDEALLY CATERING STAGING ON EACH LEVEL & SEPARATE CIRCULATION TO DELIVERY POWER + COFFEE + REFRIGERATION + OFFICE?

CONTACT HOUSING FOOD SERVICES

- 250 SANDWICHES FOR SATELLITES
- ENTREES, SALADS
- 6 LOCAL VENDORS - DIST'D TO SATELLITES
- SUSHI CONTRACTOR ON-SITE
- "OPPORTUNITY" STUDENTS W/ DEVELOPMENTAL DISABILITIES
- ~~ALL~~ LABOR IS STUDENTS - LIMITS MENU MUCH — 20-25 AT KITCHEN ALONE
- 8 PERMANENT STAFF, 4 1/2 IN PRODUCTION

NEED TO PLAN FOOD / CONFERENCE / CONCERT TOGETHER TO FIND SYNERGIES

# CONFERRING

4

MARKETING STUDY MOSTLY TARGETS  
150 - 200 SIZE, A SMALL  
NUMBER LARGER.

HOURS OF OPERATION - CURRENTLY 7AM - 9PM  
ACROSS ALL VENUES

- PUB CHANGES HOURS  
POSSIBLY EXTEND BUZZ AS WELL  
TIE TO EVENTS?
- ASPIRE TO 24 HOUR ZONE IN BLDG.

## LOADING DOCK (CONT'D)

- 4 BAYS
- RAMP
- DUMPSTERS
- ALL SIZES OF VEHICLES
- PARKING (4-5 VEHICLES)

MORE DELIVERIES EARLY  
CATERING ALL DAY

EVENT DELIVERIES  
FOOD VENUE DELIVERIES

DOCK HEIGHT - CURRENTLY ALL TALL

1/2 / 1/2 DELIVERIES TALL / FLAT

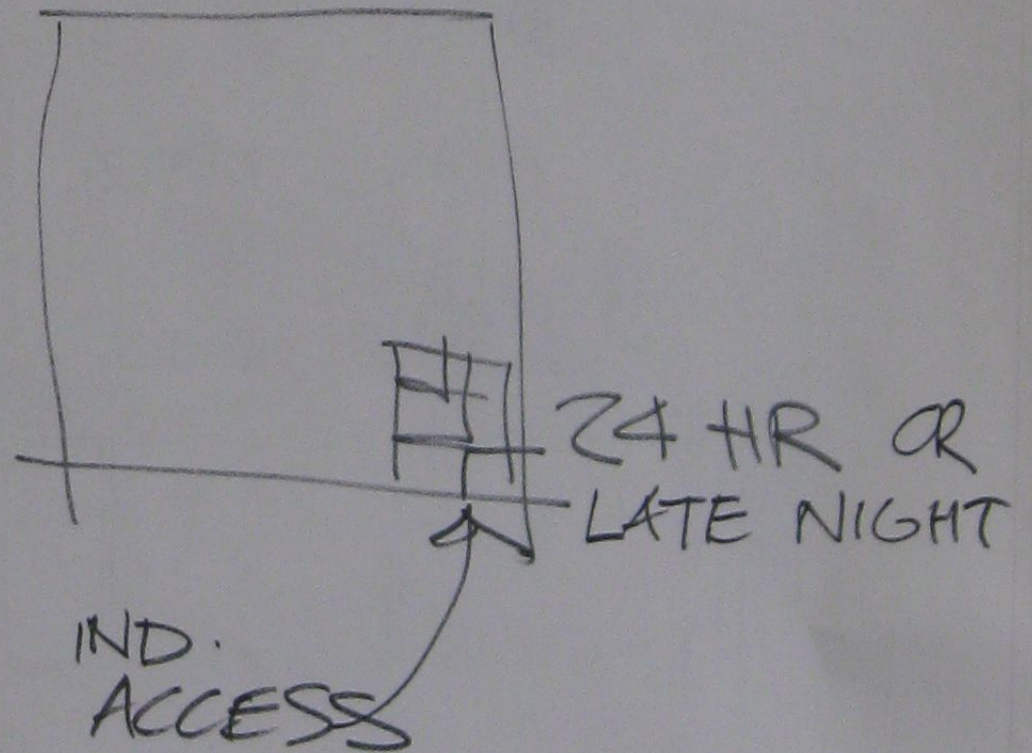

5

KITCHEN + SERVERY + STORAGE + OFFICE  
1804 # 2,604 SF 1116 # ≈ 5.6K SF

SEATING - 13,176 SF

FOOD OUTLETS 8,928 SF

COFFEE HOUSE # OFFICE/DESK 3,078 SF

SHIPPING & RECEIVING 3,600 SF

PUB # OFFICE/DESK UNI-SEX 3,880

LOCKER / RESTROOM / BREAKROOM FOR 6

CHEF OFFICE RECEIVING OFFICE ETC : 4 PEOPLE  
PROP. IN FOR STUDENT OFFICES

CATERING & PANTRY ?

NEED 100% NEW LOOK

WHETHER NEW OR RENOVATED  
& BALANCE TRADITION & FUTURE

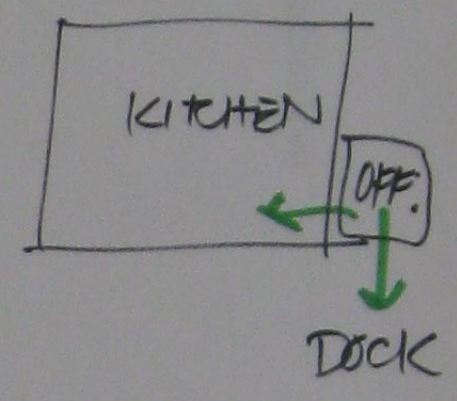

PROXIMITY TO  
~~PHO~~ CONCERT HALL  
FOR ROUL-OUT BAR ?

? LESS?

# OTHER EXAMPLES

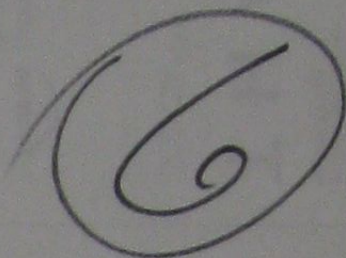

CHAPMAN UNIV.

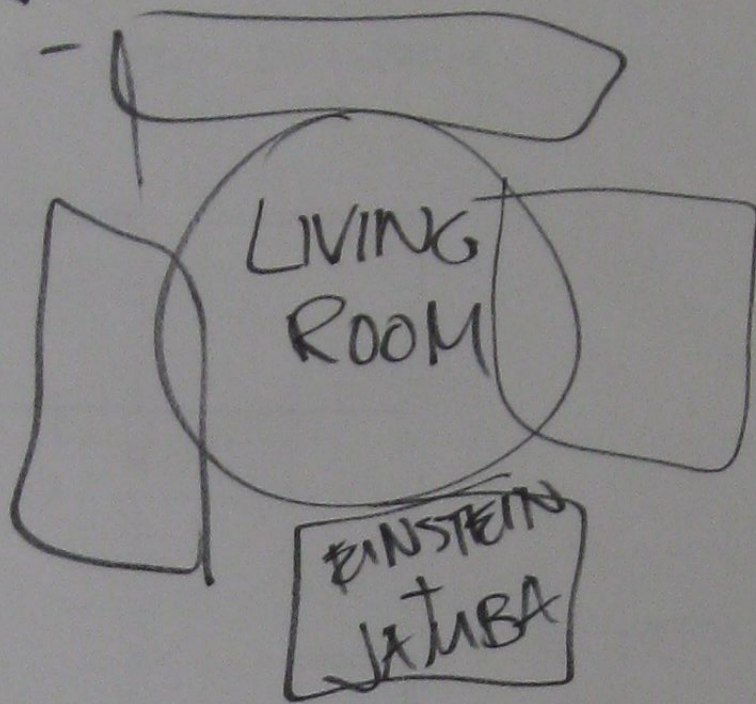

USC GASTROPUB - "THE LAB"

ADJACENT TO SPORTS VENUES

≠ OFF. CAMPUS HOUSING

180 SEATS INSIDE + 80 OUTSIDE

U.S.C. URBAN MARKET

USC SHOP CAFE, ARCHITECTURE

### Staff

8 Full Time  
 - 4 produce  
 - 2 office staff  
 Kitchen Only  
 20-25 students  
 = 12/day  
 Front of House  
 20-25  
 = 12/days

Hours of Operation  
 7:00 to 9:00  
 Pub-Cafe space

Storage for  
 4 Satellite  
 F.S. for  
 clearing Dry-Freezer

EMU  
 FS

Kitchen - Back of House  
 Freezer - Dry Storage - Drain - Dishwash  
 Loading  
 Commissary - Snacks cold salads  
 repackaging pastries from vendors - sushi prep

Dock:  
 used by Vending Machine  
 opportunity students  
 student labor

### FOOD VENDORS

Downstairs  
 Venue  
 self operated  
 Bellmark  
 Buzi  
 Cafe  
 C  
 Store  
 Vendors  
 Market

Self  
 Operation  
 Fishbowl  
 Man

Market Place  
 Pita Pit (3)  
 Qdoba  
 World of  
 Sandwiches

Panda (1)  
 own storage  
 freezer - dry  
 dishwash

Subway  
 2+

Asian  
 Cow  
 -3

Conferey  
 currently - 150,200  
 projected - 500-600

1 additional

"Food Cart"  
 small Dry Storage  
 Freezer space  
 Hood - Grill  
 most prepackaged

Comondishwash  
 (except Panda)

office

Goal:  
 independent freezer for each vendor  
 - lockers - WC  
 No Catering Kitchen  
 currently nor Expected  
 only  
 Catering pantry: on each level  
 Sink - Working carts Ice maker  
 floor in etc.  
 minimize catching visibility  
 - behind door corridors  
 elev.  
 special cooking for events  
 shared







