



WALLS TRANSITION FROM 1800S BOX AND PLANK CONSTRUCTION TO THE FUTURE'S SIPS AND LIVING WALLS

THE HALLER HOUSE BECOMES A NATIONAL PARK SERVICE VISITOR CENTER



BURNT WALLS ARE PORTALS FROM A LIFE IN A HISTORICAL WORLD TO A SUSTAINABLE LIFESTYLE OF THE FUTURE

- ACTS AS MODEL HIGHLIGHTING PROGRESSIVE SUSTAINABLE EFFORTS WITHIN THE RESERVE.
- SERVES AS A FOCAL POINT FOR RESERVE INFORMATION AND ORIENTATION
- TEMPORARY EXHIBITS
- EDUCATIONAL FILMS
- RETAIL SALES OUTLET FEATURING RESERVE BRANDED PRODUCTS AND PRODUCE.



- COMMUNITY GARDENS
- ART STUDIOS
- BICYCLE REPAIR WORKSHOPS
- READING DEN
- WIRELESS INTERNET
- OUTDOOR GEAR RENTALS
- COMMUNITY SERVICE
- CIRCUIT THEATRE PLAYS
- HEALTH AND YOGA CLASSES

THE TALLER HOUSE



"WE MUST USE TIME AS A TOOL, NOT AS A CRUTCH."
-JFK

ARC OF TIME DESIGNING THE FUTURE TO RESPECT THE PAST MICHAEL BOWLES "AN ABUNDANT LAND FILLED WITH MEMORIES... PRESERVES THE PAST FOR THE FUTURE."



SITE PLAN 1/16" = 1'

N
^



THE HALLER HOUSE WAS ONE OF COUPEVILLE'S EARLIEST HOMES, BUILT IN 1866. THE HALLER STORE WAS SOON ADDED TO THE HOUSE ONLY TO BE CUT IN HALF BY THE WIDENING OF MAIN STREET IN 1889. THE HALLER HOUSE BECAME COUPEVILLE'S FIRST THEATRE, THE CIRCUIT, IN THE EARLY 1900S. THE HOUSE CAUGHT FIRE IN 1940. FIRE QUICKLY CLIMBED THE VERY FLAMMABLE BOX AND PLANK CENTRAL WALL. ALTHOUGH THE HOUSE'S SPINAL CORD WAS BURNT, THE SHELL AND SPIRIT REMAINED. IN 2010 A NEW TYPE OF FISSURE WILL SPLIT THE HALLER HOUSE ONCE AGAIN AND LEAVE ITS MARK IN THE ARC OF TIME; THE SIGNATURE OF SUSTAINABILITY.

SITE SECTION 1/16" = 1'

<N

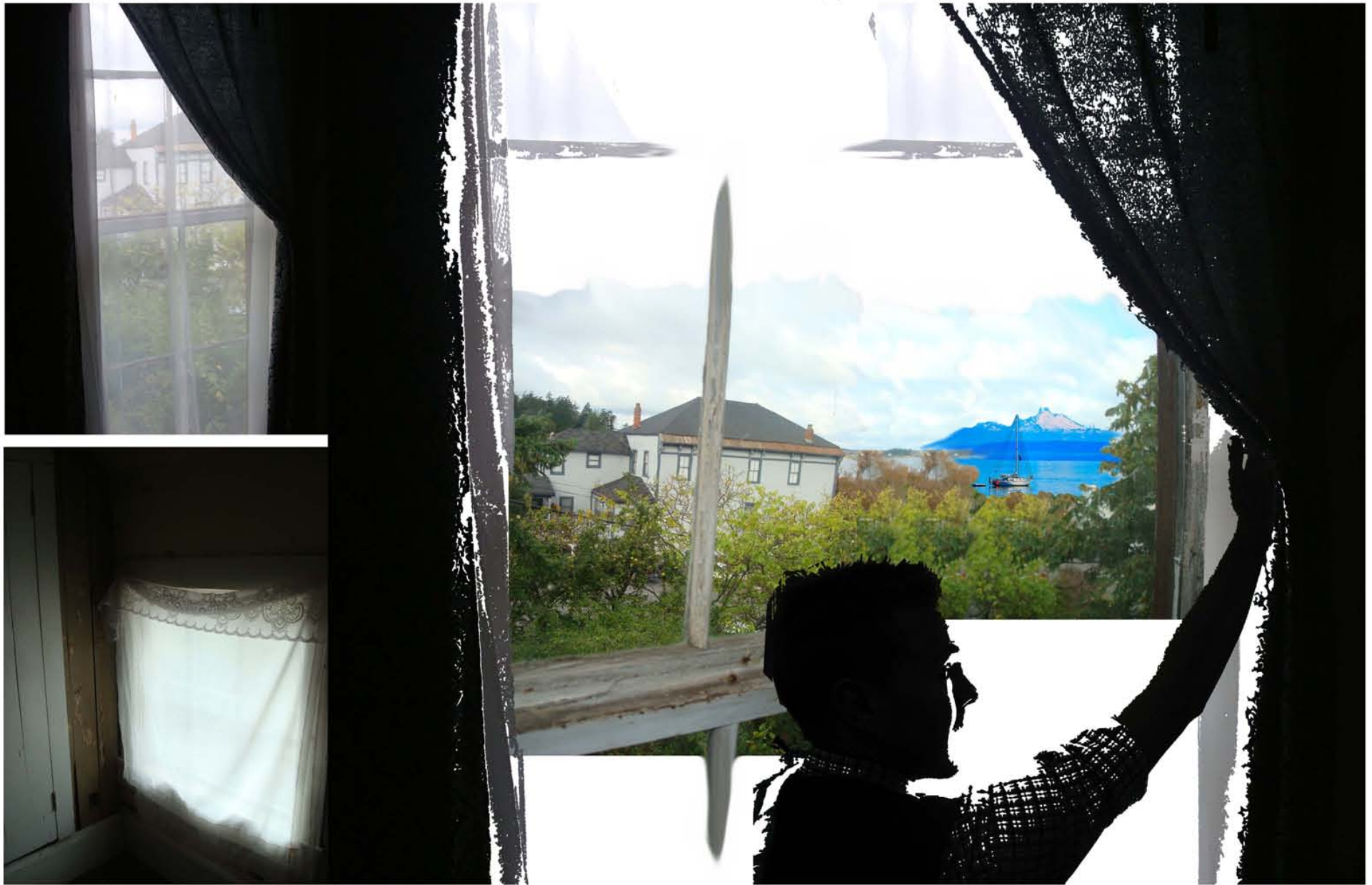
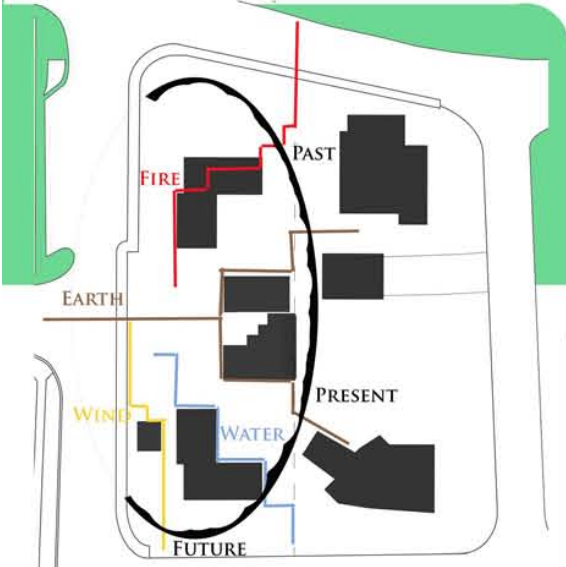
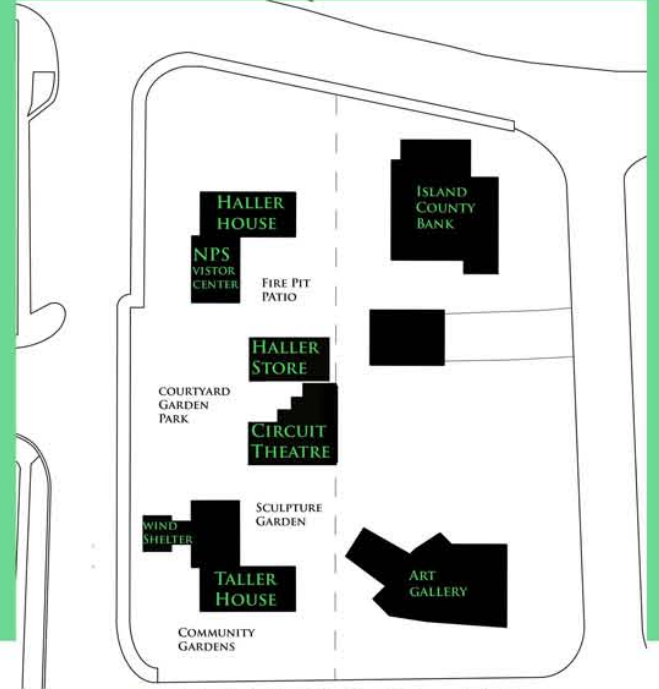

UNFOLDING COURTYARDS

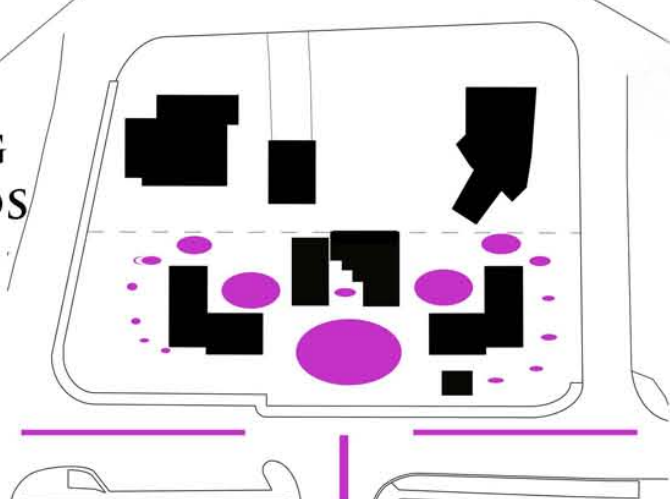

THE WIND SHELTER AND HALLER HOUSE PROVIDE VIEWS OF MT. BAKER AND THE WHARF.

