

## Student Recreation Center Expansion and Renovation



University of Oregon  
Project User Group Meeting 1B  
October 6, 2011, 11:00 am – 12:30 pm



## Top 4 Identified Program Priorities

- Priority 1 – Aquatics

- WAS IMPORTANT 12 years ago!

- Priority 2 – Court Sports

- NOTE: LOOSING MC COUNT DRIVES THIS.  
- NEED OPEN REC - NOT JUST BB!

- Priority 3 – Weights & Fitness

- NEED TO DOUBLE SIZE of WTS & FITNESS. GROWING!  
- Balance BTWX PE & REC.

- Priority 4 – Way Finding

- ONE SHOT TO DO IT RIGHT.

BUDGET

\$ 61 m. (6 BONDS)

↓  
\$ 50 m. (NO BONDS)

May be future  
PHASES

CONFIRMED!

## Evaluate Impact on Design Values / Goals / Patterns

---

- Enough Space and Capacity
- Leave the Good Parts Alone
- Future Expansion

- Aquatic Program Scenarios
  - Top Priority Spaces
  - Mix ‘n Match?
  - What’s Needed for PE & Rec?
- Initial Observations on Leighton Pool
  - Current Opinions about Leighton Pool
- Area / Cost Model Scenarios & Diagrams
  - How much can we accomplish for \$35 M?
  - Review Three Scenarios
- Site Layouts – Where do we Build?
  - Review Three Blocking Scenarios

## Scenario 1

# Relocate

**Strategy 1:** Reserve 100,000 square feet of buildable space in area now being considered for SRC expansion so that before Esslinger is demolished PE and Rec spaces can be replaced in this reserved area.



## Scenario 2

# Replace

**Strategy 2:** Reconstruct PE/Rec as part of new building at Esslinger site with the likely loss of use for lengthy periods of time during reconstruction.

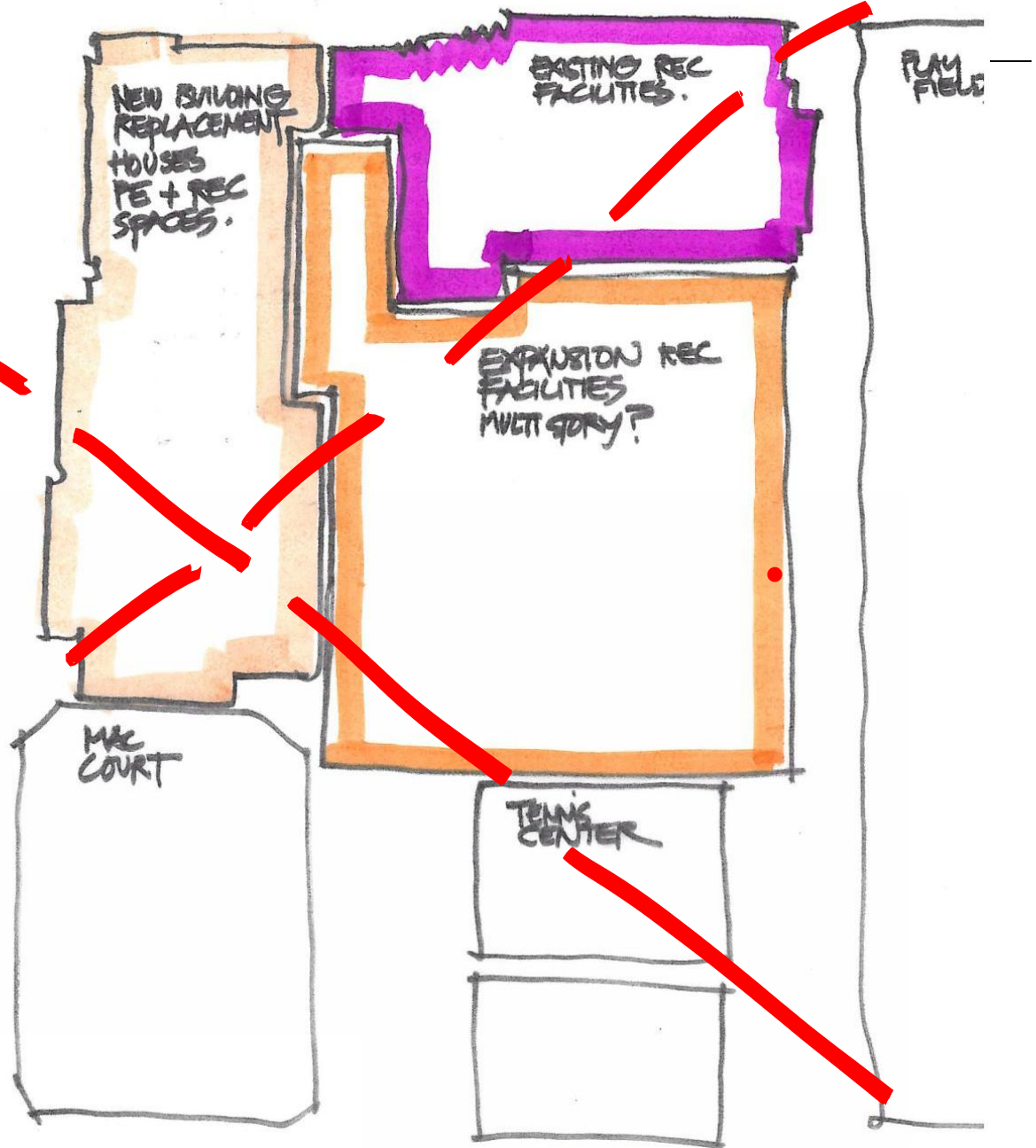



## Scenario 3

# Renovate

**Strategy3:** Esslinger is not demolished and PE/Rec spaces stay in place and are renovated as needed over time.

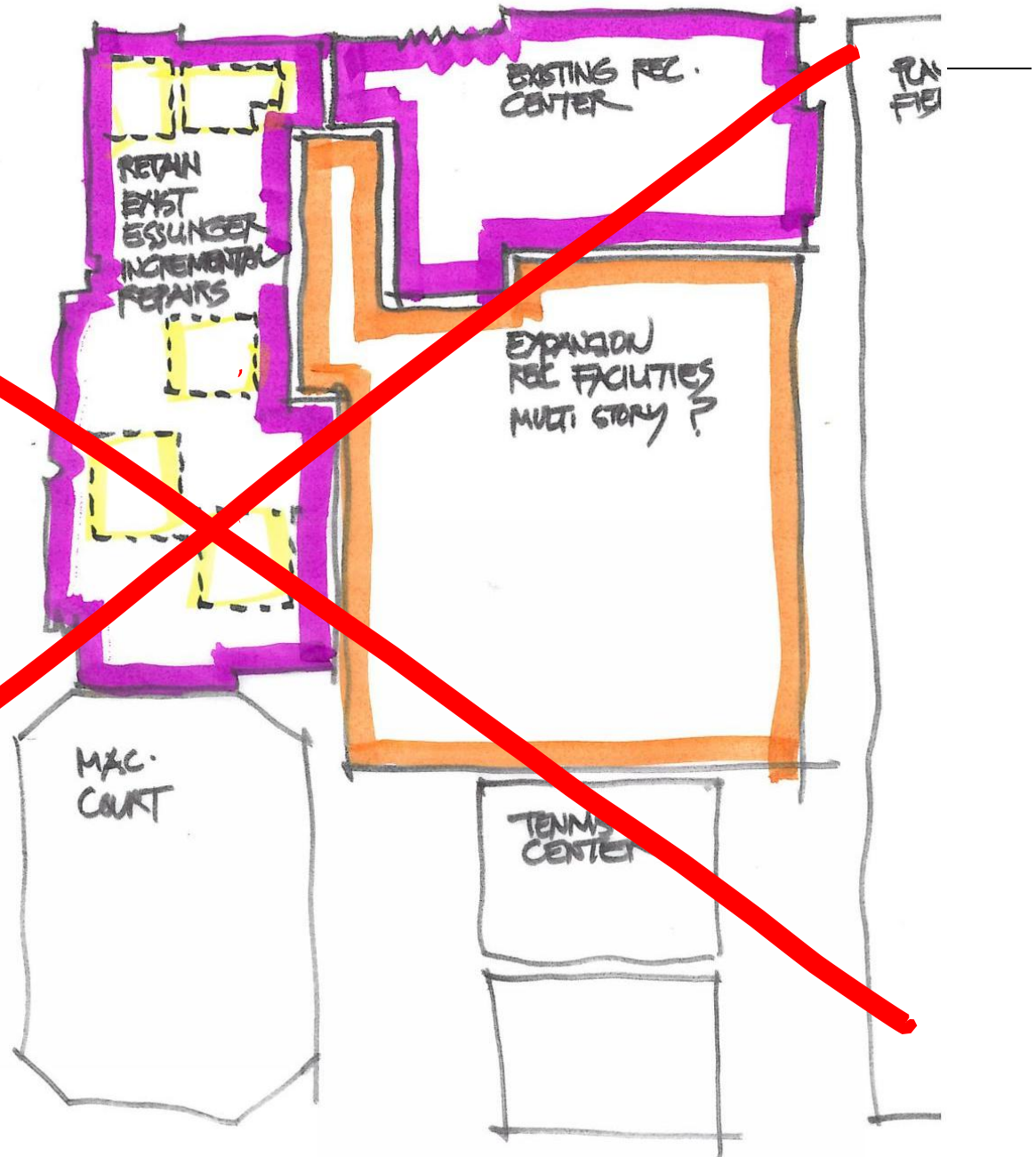

## Evaluate Impact on Design Values / Goals / Patterns

---

- Enough Space and Capacity
- Leave the Good Parts Alone
- Future Expansion



## Preliminary Site Opportunities & Constraints

---

- Building Site
- Adjacent Parcels
- What are we working with?

## Wrap Up

- Conclusions Reached

- ☐ Replace lightning pool <sup>13</sup>

- ☐ 50m a NOT?

Verification Environment & operation of programming = good  
use multiple pools, instead

- ☐ SINS Option

- Scenario #1 Preferred

- FDR'S

- Concept DEV Scenarios

- More programming

- More SWE Detail

- Look Ahead

- Set direction for work to be accomplished for next User Group

WK of OCT 24, 2011