

FEATURES & SPECIFICATIONS

INTENDED USE — For applications that require medium to high light levels such as manufacturing, warehousing, storage, retail or task lighting. Ideal for mounting heights up to 25'.

Attributes: Heavy-duty design for demanding industrial environments. Pressure-lock lampholders enclosed in snap-in turret housing. Available in 4' or 8' lengths. 6" lamp spacing of 2-lamp models, 3" lamp spacing on 3-lamp models. Solid top, 10% or 20% uplight reflectors available, painted after fabrication.

CONSTRUCTION — Die-embossed reflector constructed of heavy gauge cold-rolled steel. White enamel reflector finish standard, porcelain finish optional.

Finish: Five-stage iron-phosphate pretreatment ensures superior paint adhesion and rust resistance. Finish is high-gloss baked white enamel.

ELECTRICAL — Thermally protected, resetting, Class P, HPF, UL listed, CSA Certified ballast is standard. Energy saving and electronic ballasts are sound rated A.

Fixture is suitable for damp locations. AWM, TFN or THHN wire used throughout, rated for required temperatures.

INSTALLATION — For surface or suspended mounting, unit or row installation.

LISTINGS — UL Listed for 25°C ambient temperatures. 120V, 277V and MVOLT are UL Listed and CSA Certified (standard). 347V is CSA Certified (see Options). NOM Certified (see Options).

WARRANTY — 1-year limited warranty. Full warranty terms located at www.acuitybrands.com/CustomerResources/Terms_and_conditions.aspx.

Ballast warranties provided through the component manufacturers.

Actual performance may differ as a result of end-user environment and application.

Note: Specifications subject to change without notice.

Catalog Number
Notes
Type

Heavy-Duty Turret Industrial

AF



4' or 8' lengths
1, 2, 3 or 4 lamps

Specifications

Length: 49-13/16 (126.5) or 99-5/8 (253.0)

Width: 13-3/8 (34.0)

Height: 6-5/8 (16.8)

All dimensions are inches (centimeters) unless otherwise indicated.

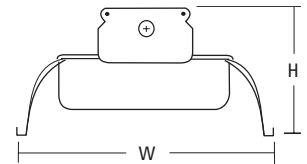

ORDERING INFORMATION

For shortest lead times, configure product using **bolded options**.

Example: AF 3 32 MVOLT GEB10IS

Series	Number of lamps	Lamp type	Voltage	Options
AFST Solid reflector	1	32 32W T8 (48")	120	<u>Shipped installed in fixture</u>
AF10 10% uplight apertured reflector	2	48 38W T12 slimline (48")	277	GEB Electronic ballast, ≤20% THD ¹
AF 20% uplight apertured reflector	3	96T8 59W T8 slimline (96")	347	GEB10IS T8 electronic ballast, ≤10% THD, instant start
	4	<u>HO lamps</u>	MVOLT	GEB10RS T8 electronic ballast, ≤10% THD, rapid start ²
For tandem double-length unit, add prefix T.	Not included	48HO 60W T12 800MA (48")		GEB10PS Electronic ballast, ≤10% THD, programmed start
Example: TAF10		48T8HO 60W T8 slimline (48")		EL Emergency battery pack (nominal 300 lumens), see Life Safety Section ³
		96HO 110W T12 800mA (96")		GLR Internal fast-blow fusing (add X for external) ³
		96T8HO 86W T8 300mA (96")		GMF Internal slow-blow fusing (add X for external) ³

PLF_ Plug-in wiring, Specify 1, 2 or 3 branch circuits & hot wires (A = black, B = red, C = blue, AB or AC)

TILW Tandem in-line wiring

CSA CSA Certified (347V only)

Accessories

Order as separate catalog number

ACEP	Full-depth endplates (1 pair)
HRUN	Hooker® T-bar hanger for 5" channel (flush to ceiling)
HRUN1	Hooker® T-bar hanger for 5" channel (1-1/2" from ceiling)
SQ_	Swivel stem hanger (specify length in 2" increments)
1B	Ceiling spacer (1-1/2" to 2-1/2" from ceiling).
HC36	Chain hangers (1 pair, 36" long).
THUN	Tong hanger for 5" channel
WGAFPV	Wireguard, 4' white (order 2 for 8' fixtures)
DLAF ME	4' 30° x 30° metal eggcrate louver (order 2 for 8' fixtures)
DLAF A12	4' framed acrylic prismatic lens (order 2 for 8' fixtures)

Notes

- Available for 96 (T12) and 48HO (T12).
- Available for 96HO and 347V.
- Specify voltage.

MOUNTING DATA

For unit or row installation. Surface or stem mounting.¹
UNIT INSTALLATION — Minimum of two hangers required.
ROW INSTALLATION — One hanger per fixture plus one per row required.

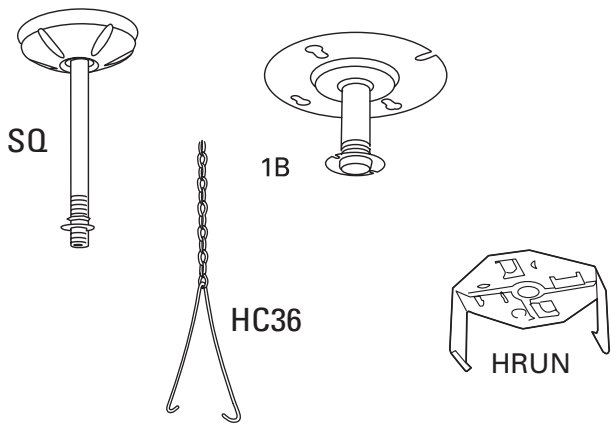

DIMENSIONS

A = 1/4 x 1/2 (64 x 13) Oval Hole
C = 7/8 (22) Dia.K.O.
D = 11/16 (17) Dia. K.O.
E = 2 (51) Dia. K.O.
F = 7/16 (111) Dia. K.O.
All dimensions are inches (millimeters).
Specifications subject to change without notice.

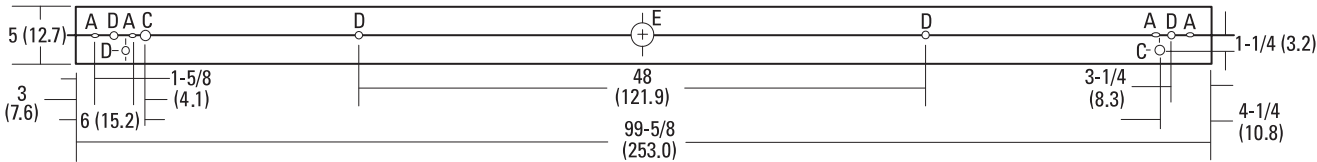
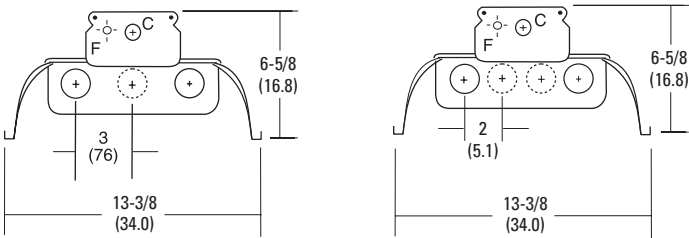

Energy (Calculated in accordance with NEMA standard LE-5)					
LER.FW	ANNUAL ENERGY COST*	LAMP DESCRIPTION	LAMP LUMENS	BALLST FACTOR	WATTS
74	\$3.24	(2) F32T8	2800	.88	60

*Calculated in accordance with NEMA Standards LE-5.

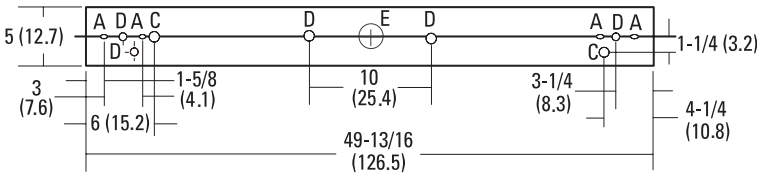

PHOTOMETRICS

Calculated using the zonal cavity method in accordance with IESNA LM41 procedure. Floor reflectances are 20%. Lamp configurations shown are typical. All data based on 25°C.
Full photometric data on these and other configurations available upon request.

AF 2 32
Report ITL 5711
S/MH 1.4

Coefficient of Utilization

	80%			70%			50%		
	70%	50%	30%	70%	50%	30%	50%	30%	10%
1	94	90	86	90	86	83	79	76	74
2	86	79	73	82	75	70	69	65	61
3	78	69	62	74	66	60	61	56	52
4	72	61	54	68	59	52	54	48	44
5	65	54	46	62	52	44	48	41	37
10	43	31	24	41	30	23	28	22	18

Zonal Lumens Summary

Zone	Lumens	%Lamp	%Fixture
0-30	998	17.2	19.0
0-40	1677	28.9	31.9
0-60	3126	53.9	59.6
0-90	4074	70.2	77.6
90-180	1175	20.3	22.4
0-180	5249	90.5	100.0

FEATURES & SPECIFICATIONS

INTENDED USE — The Avante 2x4 is a general lighting luminaire for large spaces including open offices, circulation areas, classrooms, libraries, cafeterias, airport ticketing and wait areas, and numerous other commercial applications. Static or air functions available.

CONSTRUCTION — Constructed to comply with New York City electric code. Made in USA.

Housing is gloss white enamel on cold rolled steel. All edges hemmed or rounded.

All shieldings pivot on light traps and swing down for easy lamp access.

Molded light traps prevent light leaks between shielding and endplates.

All air and screw slot units supplied with screw-on tee bar clips. Ballast access is from below.

OPTICS — Twin matte white polyester powder paint finished reflectors provide uniform light distribution. Optional low brightness diffuse aluminum stepped reflectors available.

All diffusers control direct light distribution and glare by shielding lamps from direct view.

Metal diffuser staggered round holes (MDR) 52% open perforated metal with .075" diameter holes backed with white acrylic diffuser.

Straight blade louver (SBL) sides of perforated metal with staggered round holes and solid blade louvered center. Sides and louver backed with white acrylic diffuser

ELECTRICAL — All ballasts supplied are class P, thermally protected, resetting, HPF, non-PCB, UL Listed, CSA Certified. Ballasts are sound rated A. Standard combinations conform to UL 935.

INSTALLATION — Trims available for standard 1" and 9/16" tee bar or screw slot grids.

Fixtures can be row mounted end-to-end.

Drywall ceiling adapters available.

LISTINGS — UL Listed.

WARRANTY — 1-year limited warranty. Complete warranty terms located at www.acuitybrands.com/CustomerResources/Terms_and_conditions.aspx

Avante is covered by one or more of the following patents: 5,988,829; 399,586; 411,641; 413,402; 2,212,513; 87,513.

Note: Specifications subject to change without notice.

Catalog Number
Notes
Type

Avante
Direct/Indirect Lighting

2AV 2'X4' NY

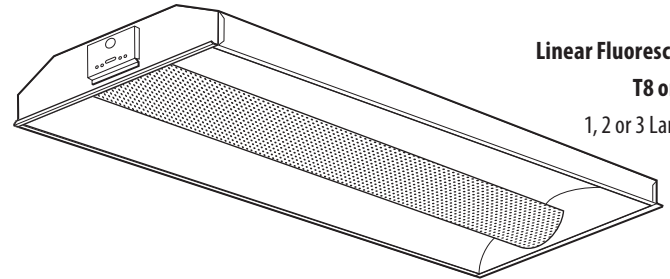

Linear Fluorescent
T8 or T5
1, 2 or 3 Lamps

Specifications	
Length:	48 (121.9)
Width:	24 (61.0)
Diffuser width:	8 (20.3)
Depth:	5-1/2 (14.0)

All dimensions are inches (centimeters) unless otherwise indicated.

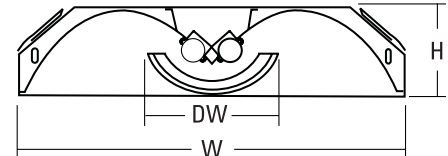

ORDERING INFORMATION

For shortest lead times, configure product using **standard options (shown in bold)**.

Example: 2AV G 2 32 MDR MVOLT GEB10IS NY3

2AV							MVOLT	
Series	Trim type	Air function	Number of lamps	Lamp type	Diffuser	Voltage	Options	
2AV 2' wide	G Grid trim ST Screw slot	(blank) Static (no air function) A Air return/supply	1 2 3 Not included.	28T5 28W T5 (46") 54T5HO 54W T5HO (46") 32 32W T8 (48")	MDR Metal diffuser, round holes SBL Straight blade louver, round holes	MVOLT¹	GEB10IS T8 Electronic ballast, ≤10% THD, instant start GEB10PS Electronic ballast, ≤10% THD, program med start ALG Acrylic litter guard ² EL14 Emergency battery pack (nominal 300 lumens, see Life Safety section) GLR Internal fast-blow fuse ³ LP Lamped. Specify lamp type and color PWS1836 6' prewire, 3/8" dia., 18-gauge, 3 wires NY3 I.B.E.W. Local 3 union made <u>Reflector option</u> ASR Aluminum stepped reflector	

Accessories: Order as separate catalog number.

DGA24 Drywall ceiling adapter, unit installation. Use G trim plus DGA accessory for fixture trim flange and fixture support in plaster or plasterboard ceilings.

Notes

¹ MVOLT (120 - 277 volt), where available.

² Refer to options and accessories section for more detailed information.

³ Must specify voltage, 120 or 277.

2AV 2X4 NY Direct/Indirect Lighting

2AV G 2 32 MDR, (2) 32W T8 lamps, 2850 lumens per lamp, s/m 1.2 (along) 1.3 (across), test no. LTL 10121

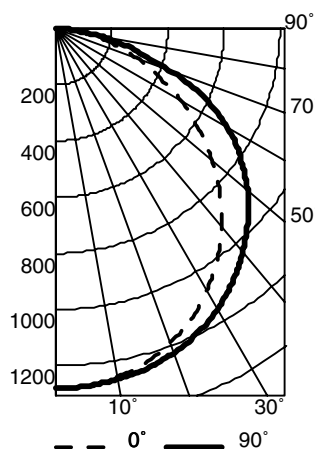

CP Summary			Coefficients of Utilization										Zonal Lumen Summary					
			pf	80%			20%			50%								
				pc	70%	50%	30%	70%	50%	30%	10%	50%					30%	10%
0°	1280	1280	0	81	81	81	79	79	79	76	76	76	0° - 30°	1010	17.7	26.0		
5°	1279	1277	1	74	71	68	69	66	64	66	64	62	0° - 40°	1669	29.3	43.0		
15°	1233	1253	2	67	61	57	60	56	52	58	54	51	0° - 60°	3015	52.9	77.7		
25°	1141	1194	3	61	54	48	53	47	43	50	46	42	0° - 90°	3882	68.1	100.0		
35°	1005	1101	4	56	47	41	46	41	36	45	40	36	90° - 180°	0	0.0	0.0		
45°	828	969	5	51	42	36	41	36	31	40	35	31	0° - 180°	3882	68.1	100.0		
55°	623	806	6	47	38	32	37	31	27	36	31	27						
65°	406	590	7	44	34	28	34	28	24	33	27	24						
75°	211	291	8	41	31	25	31	25	21	30	25	21						
85°	46	64	9	38	29	23	28	23	19	27	22	19						
90	0	0	10	36	26	21	26	21	17	25	21	17	Efficiency: 68.1%					

Efficiency: 68.1%

2AV G 3 32 MDR, (3) 32W T8 lamps, 2850 lumens per lamp, s/m 1.3 (along) 1.3 (across), test no. LTL 10155

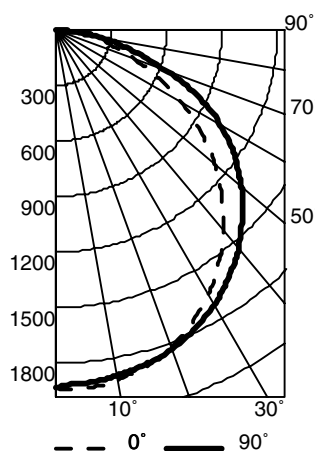

CP Summary			Coefficients of Utilization										Zonal Lumen Summary					
			pf	80%			20%			50%								
				pc	70%	50%	30%	70%	50%	30%	10%	50%					30%	10%
0°	1934	1934	0	81	81	81	79	79	79	76	76	76	0° - 30°	1529	17.9	26.2		
5°	1941	1913	1	74	71	68	69	67	64	66	64	62	0° - 40°	2527	29.6	43.3		
15°	1880	1871	2	67	62	57	60	56	52	58	54	51	0° - 60°	4552	53.2	78.0		
25°	1747	1781	3	61	54	48	53	47	43	51	46	42	0° - 90°	5837	68.3	100.0		
35°	1539	1632	4	56	48	41	47	41	37	45	40	36	90° - 180°	0	0.0	0.0		
45°	1275	1435	5	51	42	36	42	36	31	40	35	31	0° - 180°	5837	68.3	100.0		
55°	956	1179	6	47	38	32	37	32	27	36	31	27						
65°	611	849	7	44	34	28	34	28	24	33	28	24						
75°	298	431	8	41	31	26	31	25	21	30	25	21						
85°	66	90	9	38	29	23	28	23	19	28	23	19						
90	0	0	10	36	27	21	26	21	17	26	21	17						
Efficiency: 68.3%																		

Efficiency: 68.3%

For additional photometric information, visit our website at www.lithonia.com.

MOUNTING DATA

Ceiling type	Appropriate trim type
Exposed grid tee (1' and 9/16")	G
Concealed grid tee	G
Screw slot	ST
Plaster or plasterboard	G*

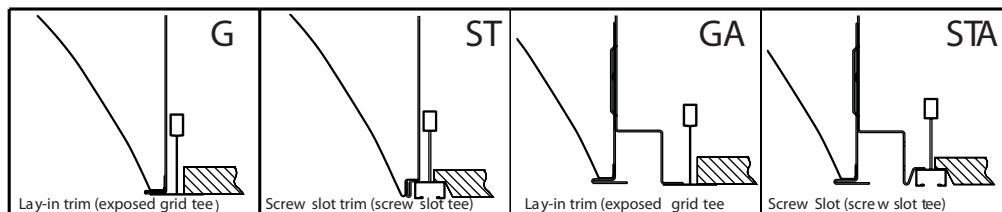

*DGA accessory available to provide ceiling trim flange and fixture support for plaster or plasterboard ceiling. Recommended rough-in dimensions for DGA installation is 24-3/4" x 48-3/4" (Tolerance is +1/8", -0").

PRODUCT INFORMATION

General Purpose

Intended Use

For applications that require good illumination levels. Suitable for general purpose applications.

Construction

Steel channel (standard) with high-gloss, baked polyester finish.

Combination end plates/channel connector furnished for either unit-mounted or continuous-row application.

Channel cover retained by quarter-turn fastener.

Optional aluminum channel available, features corrosion-resistant fasteners for use in damp and harsh locations.

White specular reflectors available. For reflectors and wireguards options, see pages 93-95.

Electrical

Thermally protected, resetting, Class P, UL Listed and CSA Certified ballast is standard. Sound rating depends on lamp/ballast combination.

AWM, TFN, THHN wire used throughout, rated for required temperatures.

Ballast disconnect provided standard where required to comply with U.S. and Canadian electrical codes.

Listings

UL Listed. CUL Listed or CSA Certified to Canadian standards. NOM Certified—optional.



ORDERING INFORMATION

For shortest lead times, configure products using **bolded options**.

Example: C 2 32 MVOLT GEB10IS

Series	Number of lamps	Lamp type	Voltage	Ballast configuration
C ^{1,7}	1	17 17W T8 (24")	MVOLT	(blank) 1- and/or 2-lamp ballasts per Lithonia Lighting standards
	2	20 20W T12 (24")	120	
	Not included.	24HO 35W T12 800mA (24") ⁴	277	1/4 One 4-lamp ballast
		25 25W T8 (36")	347 ⁵	
		30 30W T12 (36")		
		32 32W T8 (48") ¹		

Ballast	Options
GEB10IS T8 electronic ballast, ≤ 10% THD, instant start	EL Emergency battery pack ²
GEB10RS T8 electronic ballast, ≤ 10% THD, programmed rapid start	AL Aluminum body
GEB T12 electronic ballast, ≤ 20% THD	GLR Internal fast-blow fuse (add X for external) ^{8,9}
BILP T8 high-performance ballast, low ballast factor (.79), instant start	GMF Internal slow-blow fuse (add X for external) ^{8,9}
	PLF Plug-in wiring, specify 1, 2 or 3 branch circuits and hot wires (A = black, B = red, C = blue, AB or AC)
	TILW Tandem in-line wiring
	CW Cold-weather ballast; 0°F starting temp
	CSA Meets Canadian standards
	NOM Meets Mexican standards

ADDITIONAL INFORMATION

For additional product information, visit www.lithonia.com.

CONFIGURATIONS					
SERIES	LAMPS PER CROSS SECTION	LAMPS PER FIXTURE	LAMP TYPE	LENGTH IN. (CM)	WIDTH IN. (CM)
C/CAL	1,2	1,2	17, 20	24 (61.0)	4-1/4 (10.8)
CAL	1,2	1,2	24HO	24 (61.0)	4-1/4 (10.8)
C	1,2	1,2	CF39	24 (61.0)	4-1/2 (11.4)
C/CAL	1,2	1,2	25, 30	36 (91.4)	4-1/4 (10.8)
C	1,2	1,2	CF40	36 (91.4)	4-1/2 (11.4)
CAL	1,2	1,2	36HO	36 (91.4)	4-1/4 (10.8)
C/CAL	1,2	1,2	32, 48	48 (121.9)	4-1/4 (10.8)
CAL	1,2	1,2	48HO	48 (121.9)	4-1/4 (10.8)
C	1,2	1,2	CF50	48 (121.9)	4-1/2 (11.4)
C/CAL	1,2	1,2	72	72 (182.9)	4-1/4 (10.8)
CAL	1,2	1,2	72HO	72 (182.9)	4-1/4 (10.8)
TC/TCAL	1	2	25, 30	72 (182.9)	4-1/4 (10.8)
TC/TCAL	2	4	25, 30	72 (182.9)	4-1/4 (10.8)
C/CAL	1,2	1,2	96, 96T8, 96T8HO	96 (243.8)	4-1/4 (10.8)
CAL	1,2	1,2	96HO	96 (243.8)	4-1/4 (10.8)
TC/TCAL	1	2	32	96 (243.8)	4-1/4 (10.8)
TC/TCAL	2	4	32	96 (243.8)	4-1/4 (10.8)

Drawings are for dimensional detail only and may not represent actual mechanical configuration. Dimensions are shown in inches (centimeters) unless otherwise noted.

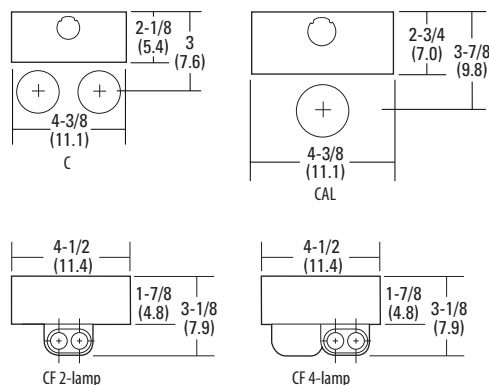
**Notes**

- For tandem double-length unit, add prefix T. Example: TC.
- Consult www.lithonia.com for available options.
- Order two 36" reflectors for 72" fixtures and two 48" reflectors for 96" fixtures.
- HO only available with aluminum (AL) version.

- Available only with CSA option.
- Not available in 347V.
- Consult factory for additional T12 AND T12HO configurations.
- Specify voltage.
- Not available in Canada.

FEATURES & SPECIFICATIONS

INTENDED USE — For general area lighting or task-specific illumination in both new construction and remodeling applications. Especially suited for conference rooms, reception areas, health care institutions, educational facilities and offices. **Certain airborne contaminants can diminish integrity of acrylic.** [Click here for Acrylic Environmental Compatibility table for suitable uses.](#)

CONSTRUCTION — Rugged universal 4" steel channel provides platform for reflector/diffuser module. A tandem unit is an 8' channel with two 4' reflector/diffuser modules. Joiners and finished ends are injection molded from tough ABS/PC blend with integral Avante white color.

All diffusers snap into place by pivoting on joiner/light trap for easy lamp access.

Injection molded joiners at each end allow fixtures to be field joined or completed as individual units with snap-on finished ends.

OPTICS — Down light, solid (DLS) reflector finished in high reflectance matte white polyester powder paint provides uniform light distribution. DLS is available with aluminum stepped reflector (ASR).

Up light, round hole perforated band (ULR) reflector finished in high reflectance matte white polyester powder paint has uniform light distribution with up light accent provided by 1-3/8" wide perforated band just above lamps.

All diffusers shield lamps from direct view.

Metal diffuser staggered round holes (MDR) 52% open perforated metal with .075" diameter holes backed with white acrylic diffuser.

Metal diffuser aligned mini slots (MDM) 46% open perforated metal backed with white acrylic diffuser. Straight blade louver (SBL) sides of perforated metal with staggered round holes and solid blade louvered center. Sides and louver backed with white acrylic diffuser.

ELECTRICAL — All ballasts supplied are class P, thermally protected, resetting, HPF, non-PCB, UL Listed, CSA Certified. Energy saving and electronic ballasts are sound rated A. Standard combinations conform to UL 935.

INSTALLATION — AVSM can be directly mounted to most ceiling surfaces. Clips provided with fixture for surface mounting on tee bar in grid tiled ceilings. With mounting accessories, fixtures can be close to ceiling stem mounted or cable mounted up to 144". Fixture must be supported every 4'. Refer to the accessories tab for information on mounting configurations and limitations. Consult National Electrical Codes specifications for through wiring limitations.

LISTINGS — UL Listed to US and Canadian safety standards (see Options). NYC approved (see Options).

WARRANTY — 1-year limited warranty. Full warranty terms located at www.acuitybrands.com/CustomerResources/Terms_and_conditions.aspx.

Note: Specifications subject to change without notice.

Catalog Number
Notes
Type

Surface/Suspended Mount Lighting

AVSM 1' X 4'

LINEAR FLUORESCENT

T8

1 or 2 Lamp



Specifications

Length: 48 (121.9)

Width: 12 (30.5)

Diffuser width: 5-1/2 (14.0)

Depth: 4-3/8 (11.1)

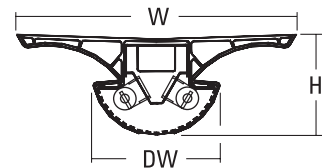

All dimensions are inches (centimeters) unless otherwise indicated.

Avante is covered by one or more of the following patents: 5,988,829; 399,586; 411,641; 413,402; 2,212,513; 87,513.

ORDERING INFORMATION

Lead times will vary depending on options selected. Consult with your sales representative.

Example: AVSM 2 32 MDR DLS 120 GEB10IS

Series		Number of lamps	32	Lamp type	Diffuser	Light distribution		Voltage	Options	
AVSM	1' wide	1	32	32W T8 (48")	MDR	Down light, solid	DLS	120	GEB10IS	Electronic ballast, ≤10% THD, instant start
TAVSM	1' Wide, 8' long unit with 4' lamps end to end	2 Not included.			SBL	Up light, round holes ¹	ULR	277 347 ² MVOLT ³ Others available.	GEB10PS	Electronic ballast, ≤10% THD, programmed start
					MDM				ALG	Acrylic litter guard ⁴
					Others available.				EL	Emergency battery pack (nominal 300 lumens, see Life Safety section)
									GLR	Internal fast-blow fuse ⁵
									LP___	Lamped. Specify lamp type and color
									CSA	Listed and labeled to comply with Canadian Standards
									NY3	New York City approved
									<u>Reflector option</u>	
									ASR	Aluminum stepped reflector

Accessories: Order as separate catalog number.⁴

AVACF___	Avante adjustable cable feed accessory kit for grid ceiling.
AVACF___4W	Avante adjustable four-wire cable feed accessory kit for grid ceiling.
AVAC___	Avante adjustable cable non-feed accessory kit for grid ceiling. Fixture must be supported every 4'.
SQ___	Swivel hanger; specify in 2" increments. Fixture must be supported every 4'.

Notes

- For suspended mounting only.
- Not available with GEB10PS.
- MVOLT (120 - 277 volt).
- Refer to options and accessories tab for more detailed information.
- Not available with MVOLT.

AVSM 1 x 4 Linear Fluorescent T8

MOUNTING DATA

For unit or row installation, surface or stem mounting.

Unit installation — Minimum of two hangers required.

Row installation — One hanger per channel plus one per row required.

Hanging devices illustrated below.

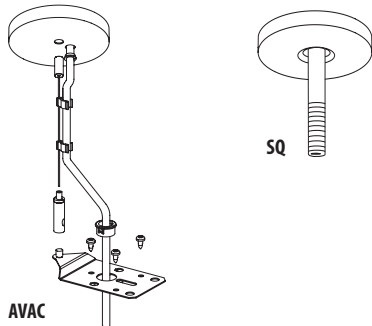

KEY: A = 5/8" Knockout

B = 7/8" Knockout

C = 2" Double Knockout

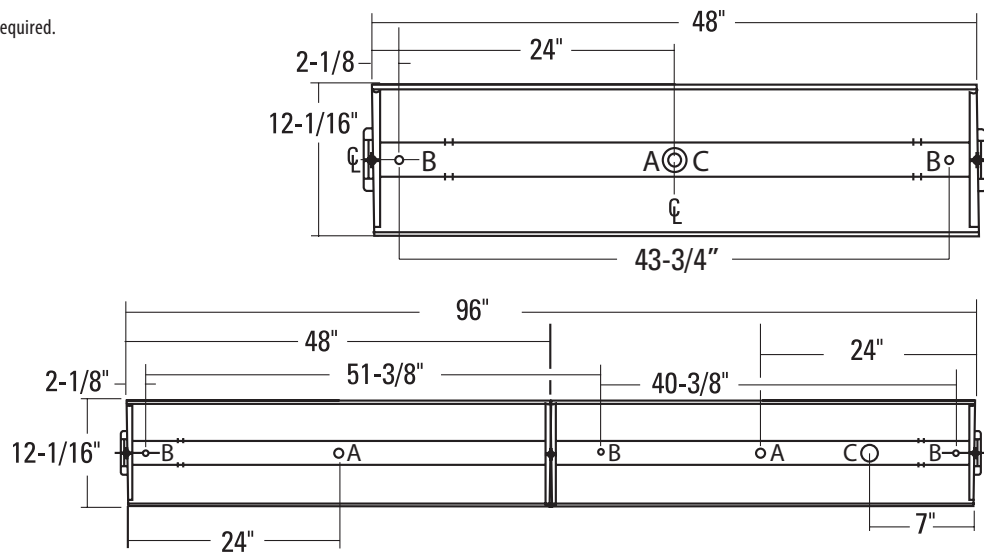

AVSM 2 32 MDR DLS, (2) 32W T8 lamps, 2850 lumens per lamp, s/m 1.2 (along) 1.4 (across), test no. LTL 9446

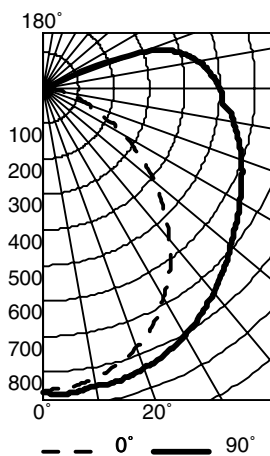

CP Summary		Coefficients of Utilization										Zonal Lumen Summary				
		pf	20%						50%							
		pc	70%													
		pw	70%	50%	30%	50%	30%	10%	50%	30%	10%	Zone	Lumens	% Lamp	% Fixture	
0°	858	858	0	75	75	75	73	73	73	67	67	67	0° - 30°	678	11.9	18.3
5°	846	863	1	66	62	59	60	57	54	55	53	50	0° - 40°	1121	19.7	30.2
15°	807	852	2	60	53	48	51	46	42	47	43	40	0° - 60°	2059	36.1	55.5
25°	735	823	3	54	46	40	44	39	34	41	36	33	0° - 90°	3196	56.1	86.1
35°	625	779	4	49	41	34	39	33	29	36	31	27	90° - 120°	516	9.0	13.9
45°	486	722	5	45	36	30	35	29	25	32	27	23	90° - 130°	516	9.0	13.9
55°	335	667	6	41	32	26	31	25	21	29	24	20	90° - 150°	516	9.0	13.9
65°	193	618	7	38	29	23	28	23	19	26	21	18	90° - 180°	516	9.0	13.9
75°	92	573	8	36	27	21	26	20	17	24	19	16	0° - 180°	3711	65.1	100.0
85°	30	510	9	33	24	19	24	18	15	22	17	14	Efficiency: 65.1%			
90	11	500	10	31	22	17	22	17	13	20	16	13				

AVSM 2 32 SBL DLS ASR, (2) 32W T8 lamps, 2850 lumens per lamp, s/m 1.1 (along) 1.6 (across), test no. LTL 9576

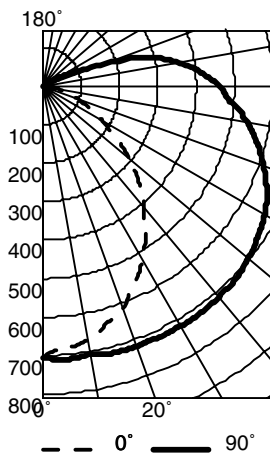

CP Summary		Coefficients of Utilization										Zonal Lumen Summary					
		pc	80%			70%			50%								
		0°	90°	pw	70%	50%	30%	50%	30%	10%	50%	30%	10%	Zone	Lumens	% Lamp	% Fixture
0°	704	704	0	65	65	65	63	63	63	59	59	59	0° - 30°	554	9.7	17.3	
5°	686	712	1	57	54	50	52	49	46	48	45	43	0° - 40°	924	16.2	28.8	
15°	640	717	2	51	46	41	44	40	36	41	37	34	0° - 60°	1748	30.7	54.5	
25°	565	719	3	46	39	34	38	33	29	35	31	28	0° - 90°	2809	49.3	87.6	
35°	469	719	4	42	35	29	33	28	24	31	27	23	90° - 120°	395	6.9	12.3	
45°	354	710	5	39	31	25	30	24	21	28	23	20	90° - 130°	397	7.0	12.4	
55°	233	683	6	35	27	22	26	21	18	25	20	17	90° - 150°	397	7.0	12.4	
65°	131	644	7	33	25	19	24	19	15	22	18	15	90° - 180°	397	7.0	12.4	
75°	66	579	8	30	22	17	22	17	14	20	16	13	0° - 180°	3206	56.2	100.0	
85°	19	493	9	28	21	16	20	15	12	19	15	12	Efficiency: 56.2%				
90	3	461	10	27	19	14	18	14	11	17	13	11					

FEATURES & SPECIFICATIONS

INTENDED USE

For wall mount – vertical or horizontal. Ideal for stairwells, corridors, lavatories or any utility application. **Certain airborne contaminants can diminish integrity of acrylic.** [Click here for Acrylic Environmental Compatibility table for suitable uses.](#)

ATTRIBUTES

Detachable, hinged service tray for ease of installation and maintenance. Night-light options available. Consult factory.

CONSTRUCTION

Housing is precision die-formed from 20 gauge cold-rolled steel. Diffuser is high-impact 50% DR acrylic.

FINISH

Five-stage, iron-phosphate pretreatment assures superior paint adhesion and rust resistance.

Painted parts finished with high-gloss, high-reflectivity baked white polyester paint after fabrication (PAF). Optional architectural black 40% gloss finish.

OPTICAL SYSTEM

High-impact acrylic lower diffuser. Optically engineered for superior light distribution and tinted to mask lamp image and control glare. Easy snap-in installation.

ELECTRICAL SYSTEM

Thermally-protected, resetting, Class P, HPF, non-PCB, UL Listed, CSA Certified ballast is standard. Luminaire is suitable for damp locations. AWM, TFN or THHN wire used throughout, rated for required temperatures.

UL/CSA listed ballast disconnect w/strain relief and leads provided standard.

LISTING

UL Listed to US and Canadian safety standards. Optional: Mexico NOM.

WARRANTY

Guaranteed for one year against mechanical defects in manufacture.

Catalog Number	
Notes	Type

Premium Wall Bracket

WP

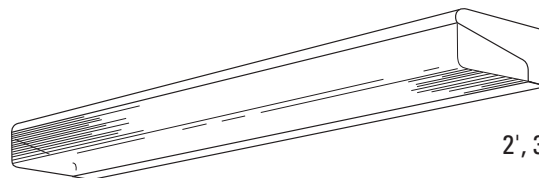

T5 and T8
2', 3' or 4' Lengths
1 or 2 Lamps

Specifications

Length: 24 (60.96), 36
(91.44) or 48
(121.92)

Width: 7-3/16 (18.26)

Depth: 3-1/4 (8.26)

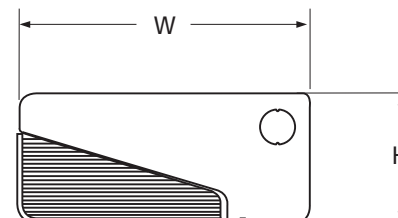

All dimensions are inches (centimeters). Specifications subject to change without notice.

ORDERING INFORMATION

For shortest lead times, configure product using **standard options (shown in bold)**.

Example: WP 2 32 MVOLT GEB10IS

WP					
Series	Lamp type	Up-light shielding type	Voltage	Options	
WP Wall bracket	17 17W T8 (24") 25 25W T8 (36") 32 32W T8 (48")	(blank) #12 pattern inverted 0.125" thick uplight lens	120 277 347	2/1 Two 1-lamp ballasts ^{2,3}	
Number of lamps	14 14W T5 (24") ¹ 21 21W T5 (36") ¹ 28 28W T5 (48") ¹	ACF125 Matte white 0.125" thick flat acrylic uplight lens	MVOLT Others available.	GEB10IS Electronic ballasts, ≤ 10% THD, instant start	
1	24 24W T5HO (24") ¹	PCL12125V #12 pattern, inverted 0.125" thick polycarbonate uplight lens		GEB10PS Electronic ballasts, ≤ 10% THD, program start	
2	39 39W T5HO (36") ¹	DO Downlight only. Standard high-impact acrylic lower diffuser, solid metal housing		EL Emergency battery pack (nominal 300 lumens); see Life Safety section	
Not included.	54 54W T5HO (48") ¹			GLR Internal fast-blow fuse	
				GMF Internal slow-blow fuse	
				TPS Tamperproof attachment of lower diffuser	
				MB Architectural black finish, 40% gloss	
				BF Internal baffle for up/down light separation ⁴	
				CO Convenience outlet; installed bottom right (120V only) ⁵	
				S1 Pull-chain switch; installed bottom left; on/off operation of all lamps only (120V only) ⁵	
				S2 Pull-chain switch; on/off operation of forward (down) lamp, rear (up) lamp remote-switched (120V only) ^{4,5}	
				S4 Pull-chain switch; four position — front only, rear only, all on, all off; installed bottom left (120V only) ^{4,5}	
				SWR Rocker switch; on/off operation of all lamps only; installed bottom right (120V only) ⁵	
				CSA Listed and labeled to comply with Canadian Standards	

NOTES:

- All T5 lamp types use GEB10PS ballast only.
- Must be specified with S2, S4 or BF options.
- BF option must be specified if separation of up and down light is desired.
- Requires 2/1 option.
- For optional locations, consult factory.
- Supplied with standard high-impact acrylic lower diffuser.
- Applications requiring mounting flush with both ceiling and wall, require DO option.

Accessories

Order as separate catalog number.

U4220 Hex base driver bit, Torx TX20, for tamper-resistant screws with center pin.

WP Wall Bracket, Premium

MOUNTING DATA

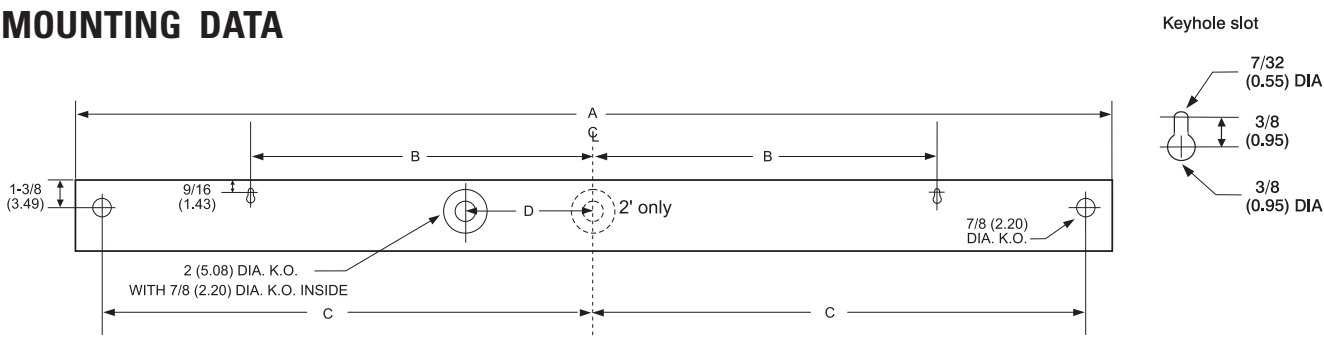

DIMENSIONS

Inches (centimeters). Subject to change without notice.

A	B	C	D
24-7/16" (62.07)	8" (20.32)	10-15/16" (27.78)	----
36-7/16" (92.55)	16" (40.64)	16-15/16" (43.02)	4-13/16" (12.22)
48-7/16" (123.03)	16" (40.64)	22-15/16" (58.26)	4-13/16" (12.22)

PHOTOMETRICS

Photometry derived in accordance with IESNA LM41 procedure. Vertical and horizontal illuminance is calculated with fixture mounted 7' above floor. Reflectances 80/50/20 %. Full photometric data available upon request.

WP 2 32
Report LTL 6508
Initial Point Illuminance on wall and horizontal work surface. (fc)

X and Y coordinates are on 12" centers.

X	A	B	C	D	E	F	G	H	I	J	K
Y											
9	3	4	4	5	6	6	6	5	4	4	3
8	3	4	4	6	8	8	8	6	4	4	3
7	4	4	5							5	4
6	4	4	4	12	22	23	22	12	4	4	4
5	4	4	4	5	7	7	7	5	4	4	4
4	4	4	4	4	4	4	4	4	4	4	4
3	4	4	3	3	3	3	3	3	3	4	4
2	4	3	3	3	4	4	4	3	3	3	4
1	3	3	3	3	4	4	4	3	3	3	3
Vert. 1	10	12	15	17	18	19	18	17	15	12	10
2	11	13	15	17	19	19	19	17	15	13	11
3	11	13	15	16	18	18	18	16	15	13	11
4	10	12	13	15	16	16	16	15	13	12	10
5	9	11	12	13	14	14	14	13	12	11	9
6	8	9	10	11	12	12	12	11	10	9	8
Horiz. 7	7	8	9	9	10	10	10	9	9	8	7
8	6	7	7	8	8	8	8	8	7	7	6
9	6	6	6	7	7	7	7	7	6	6	6
10	5	5	6	6	6	6	6	6	5	5	5
11	4	5	5	5	5	5	5	5	5	5	4
12	4	4	5	5	5	5	5	5	5	4	4
13	4	4	4	4	4	4	4	4	4	4	4

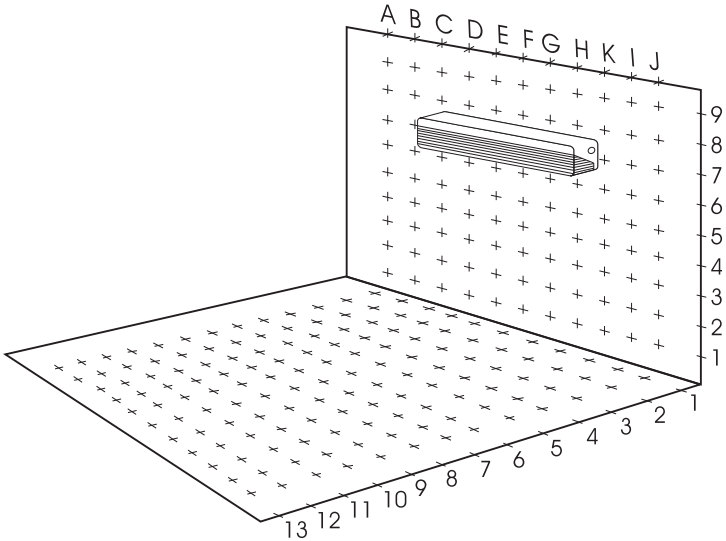

FEATURES & SPECIFICATIONS

INTENDED USE — Intended for low to medium mounting heights where dust, dirt, humidity or moisture are present. Ideal for canopies, dock areas, wastewater treatment, refrigerated areas, food processing and other non-hazardous environments. Certain airborne contaminants can diminish integrity of acrylic. [Click here for Acrylic Environmental Compatibility table for suitable uses.](#)

CONSTRUCTION — Housing formed from impact resistant, UV stabilized, fiberglass reinforced polyester with cold-rolled steel enclosed wireway. Poured in place gasketing provides a seal between housing and diffuser. Captive, corrosion-resistant cam-action latches secure the diffuser; six on 4' units, and ten on 8' units. Stainless steel latches available.

Finish: Painted parts pretreated with a five-stage iron-phosphate process to ensure superior paint adhesion and corrosion resistance, then finished with a high-gloss, baked white enamel.

OPTICS — High-impact acrylic diffuser with a stippled interior surface to spread lamp image.

PLEASE NOTE: The standard 4' diffuser is 2-1/4" deep, and the standard 8' or 48T8HO diffuser is 3" deep. To order the 4' diffuser so that it matches the depth of the 8' diffuser, order the ARDP option. The 8' diffuser is not available in the 2-1/4" depth.

ELECTRICAL — Thermally protected, resetting, Class P, HPF, non-PCB, UL Listed and CSA Certified ballast is standard.

AWM, TFN, THHN wire throughout, rated for required temperatures.

INSTALLATION — For unit or row installations, surface (ceiling or wall) or suspended mounting. Wall mounting; horizontal orientation only for use in damp locations. Stainless steel surface spring-mounting brackets standard (2 included).

LISTINGS — 120V, 277V and MVOLT are UL Listed and CSA Certified (standard). 347V is CSA Certified (see Options). NOM Certified (see Options). Listed for 25°C ambient and wet locations for covered-ceiling applications. IP65 rated. Optional IP67 rating available (supplied with 8 latches on 4' units and 14 latches for 8' units; covered ceiling not required). Compliance to FDA/USDA requirements and/or NSF splash-zone certification.

WARRANTY — 1-year limited warranty. Complete warranty terms located at

www.acuitybrands.com/CustomerResources/Terms_and_conditions.aspx

Actual performance may differ as a result of end-user environment and application.

Note: Specifications subject to change without notice.

Catalog Number
Notes
Type L-6

Enclosed and Gasketed Industrial



DMW

INSTANT, PROGRAMMED OR RAPID START

4' or 8' length
1, 2 or 3 lamps

Specifications	
Length:	50 (127.0) 98 (248.9)
Width:	8-1/8 (20.6)
Fixture depth:	5-5/8 (14.3) (deep lens) 4-3/4 (12.1) (standard lens)

All dimensions are shown in inches (centimeters) unless otherwise noted.

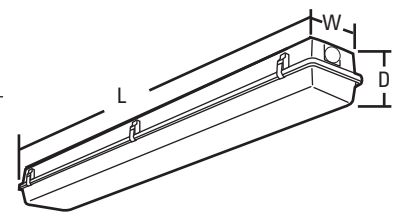

ORDERING INFORMATION

Lead times will vary depending on options selected. Consult with your sales representative.

Example: DMW 2 32 MVOLT GEB10IS

DMW									
Series	Number of lamps	Lamp type	Diffuser	Voltage	Ballast	Options			
DMW	1	28T5 28W T5 (48") ³	(blank)	120	GEB10IS	Electronic ballast, ≤10% THD, instant start	ELDW	Emergency battery pack (nominal 300 lumens) ^{7,8}	
Wet location	2	32 32W T8 (48")	2-1/4" Deep high-impact acrylic (50% DR)	277			ELSDW	Emergency battery pack (nominal 500 lumens) ^{7,8}	
For tandem double-length unit, add prefix T. Example: TDMW ¹	3 ²	48T8HO 44W T8HO (48")	3" Deep high-impact acrylic (50% DR) ⁵	347			EL6DW	Emergency battery pack (nominal 600 lumens) ^{7,8}	
		54T5HO 54W T5HO (48") ⁴	ARDP	MVOLT	GEB10RS	Electronic ballast, ≤10% THD, rapid start ⁶	EL14DW	Emergency battery pack (nominal 1400 lumens) ^{7,8}	
		96T8 59W T8 slimline (96")		others available			GLR	Internal fast-blow fusing ⁹	
		96T8HO 86W T8 380mA (96")			GEB10PS	Electronic ballasts, ≤10% THD, programmed rapid start	GMF	Internal slow-blow fusing ⁹	
							RIF1	Radio interference filter, one per fixture	
							STSL	Stainless steel latches	
							WLF	Wet location fittings (one pair; installed, top, for use with 1/2" rigid conduit)	
					GEB10PS90	T5HO 90° case temperature ballast	IP67	IP67 rated; requires 8 latches for 4' fixtures and 14 latches for 8' fixtures	
							CSA	CSA certified (only required for 347V)	
							NOM	NOM certified	
							CS89	6' white cord, 16/3, no plug, wet location	
							CS88	6' Brad Harrison 16/3 cord and straight blade plug set wet location ⁹	
							MSI_	Wet location occupancy sensor pre-wired ^{9,10}	
							DL	Damp location ¹¹	

Notes

- Not available with 96T8 or 96T8HO.
- 32W T8 and 28 T5 lamps only.
- Must specify GEB10PS ballast.
- Must specify GEB10PS90 ballast.
- ARDP standard on 48T8HO and 8' fixtures.
- Available 347V T8 only.
- Must specify voltage; 120 or 277V only.
- Check battery pack spec sheet on www.powersentrysafety.com for compatibility.
- Must specify voltage. Not available with MVOLT.
- For mounting up to 8' specify MS18; for mounting up to 20' specify MS120.
- DL option required for battery packs, sensors, and cord sets that are not wet location listed.
- For stainless steel, specify STS (ex: BCD STS).
- Brackets ship standard with fixture. For replacement purposes only.

Accessories: Order as separate catalog number.	
BCD	Bracket for hanger chain mounting. Two per package ¹²
HC36	Chain hangers (1 pair, 36" long); Requires BCD
WLF	Wet location fittings (1 pair, not installed, for use with 1/2" rigid conduit)
DMW/VRISMB	Surface mounting brackets (pair) ¹³

DMW Instant, Programmed or Rapid Start

MOUNTING DATA

For unit or row installation, surface (ceiling or wall) or suspended mounting.

DMW — Drill holes through housing and channel at appropriate locations. Includes gasketed wet location fittings on ends for power feeding/mounting. Fitting is threaded for 1/2" rigid conduit (optional WLF for top mounting). Attach to surface using fasteners and sealing washers (by others) appropriate for ceiling materials.

Unit installation — Minimum of two hangers required.

Row installation — Minimum of two hangers required. Recommended 1/2" nipple with union (by others) for DMW.

MOUNTING ACCESSORIES



BCD



HC36

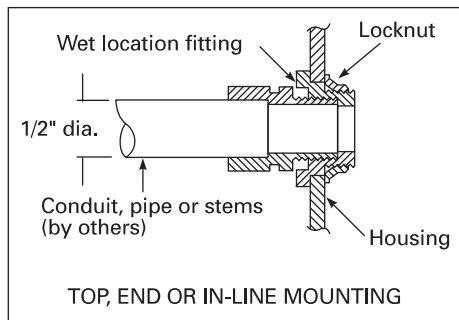

DIMENSIONS

Inches (centimeters). Subject to change without notice.

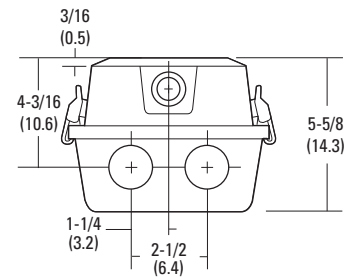
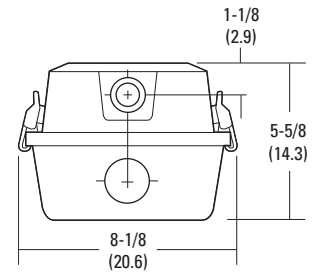

A = 11/16 (17) Dia.

B = 1-1/8 (29) Dia.

Recommended mounting locations
(field drilling required)

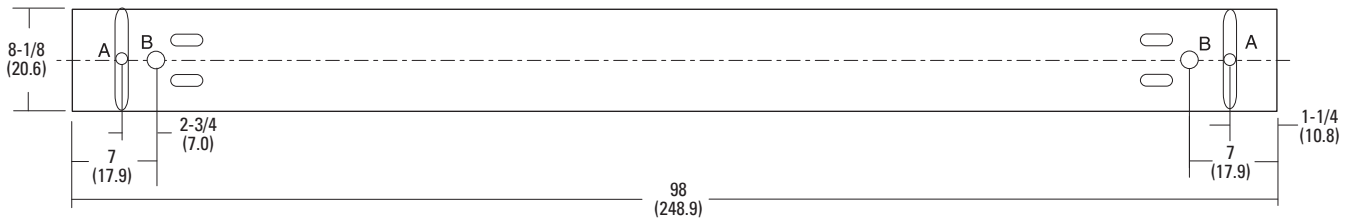
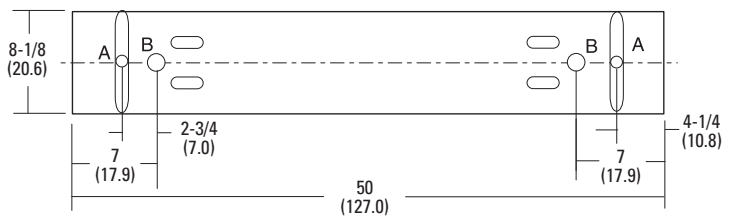

PHOTOMETRICS

See www.lithonia.com.

COMMALITE

SPECIFICATION GUIDE



Specification and Ordering Information:

1. Style:

- ☐ CML - Commalite (CML)

2. Overall Run Length:

- ☐ Specify total run length

3. Lamp Options:

- ☐ FSO - Fluorescent - Standard Output T5 (FSO)
- ☐ FHO - Fluorescent - High Output T5 (FHO)
- ☐ HP7- 3000 - High Performance LED White 3000° 7W/LF (HP7-3000)
- ☐ HP7- 3500 - High Performance LED White 3500° 7W/LF (HP7-3500)
- ☐ HP7- 4000 - High Performance LED White 4000° 7W/LF (HP7-3000)
- ☐ HP14- 3000 - High Performance LED White 3000° 10W/LF (HP10-4000)
- ☐ HP14- 3500 - High Performance LED White 3500° 14W/LF (HP14-3500)
- ☐ HP14- 4000 - High Performance LED White 4000° 14W/LF (HP14-4000)
- ☐ LED5WW- 3000 - Decorative, 290 LF Constant Voltage LED White 3000° 5W/LF (LED5WW-3000)
- ☐ LED5CW- 4000 - Decorative, 290 LF Constant Voltage LED White 4000° 5W/LF (LED5CW-4000)

4. Standoff Length:

- ☐ Specify any length 2"-36"
(For Cable Suspension - 48" Max)

5. Ballast Specification:

- ☐ LED - LED Power Supply, non-dim (LLED)
 - ☐ LED-DIM - LED Power Supply with 0-10V dimming (LED-DIM)
 - ☐ STD - Standard Electronic, non-dim <10%THD (LSTD)
 - ☐ MK7 - Advance Mark 7® Dimming 0-10V (MK7)
 - ☐ LMK10 - Advance Mark 10® Dimming (MK10)
 - ☐ HILUME - Lutron Hilume 3-D® (HILUME3D)
 - ☐ HILUME-A - Lutron Hilume A Series LED® (HILUME-A)
 - ☐ HSeries- Lutron H-SERIES® Dimming (HSERIES)
 - ☐ ECOSYS- Lutron ECOSYSTEM® Dimming (ECOSYS)
 - ☐ BALSTAR - Ballastar® Light level switching (BALSTAR)
 - ☐ USD - Superdim® Dimming (USD)
 - ☐ QUICK - Osram Quicktronic® DALI Dimming (QUICK)
- *Please consult ballast manufacturer for lamp/ballast compatability.

6. Mounting:

- ☐ *JBOX2 - 2" canopy with integral 2" splice box (JBOX2)
 - ☐ JBOX4 - 4" canopy cover plate (JBOX4)
 - ☐ TIE-BACK - Wall Tie-Back (TIE-BACK)
 - ☐ ACSUSP - Aircraft cable suspended (ACSUSP)
- * JBOX2 is standard unless otherwise noted.

7. Voltage:

- ☐ 120 volt
- ☐ 277 volt
- ☐ UNV (Universal) voltage
- ☐ 347 volt (not available in dimming)

8. Finish:

- ☐ * AL (Natural "Ultimatte" aluminum)
- ☐ BK (Black powdercoat)
- ☐ WH (White powdercoat)
- ☐ RAL (Specify RAL # of powdercoat of your choice)

* AL is standard on all Commalite product

9. Additional Options:

- ☐ OS - Occupancy Sensor (OS)
- ☐ PH - Photocell - Consult Factory (PH)
- ☐ REM - Remote Emergency Ballast (REM)
- ☐ STACK - Stack Light Mounting Option - Consult Factory (STACK)

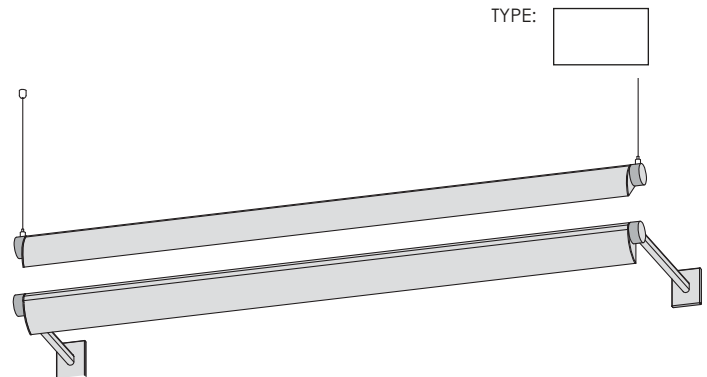

INTERNAL WHITE HIGH TRANSMISSION (93% EFFICIENT)
LENS INCLUDED ON ALL COMMALITE UNITS

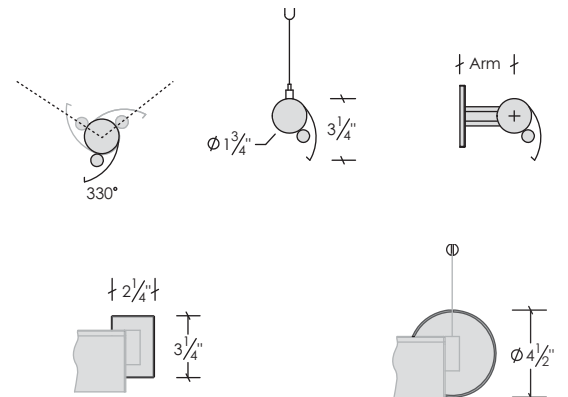

JBOX2 (2-1/4" Canopy
with integral Junction
box)

JBOX4 (4-1/2" Canopy)



TYPE:

Lamp Configuration Chart: Individual and Continuous

Regular	2'	3'	4'	5'	6'	7'	8'	9'	10'	11'	12'
14 or 24w T5	1								1		
21 or 39w T5		1			2	1		3		1	
28 or 54w T5			1			1	2		2	2	3
35 or 80w T5				1							

Typical Commalite row configurations: Additional configurations and row lengths available. Consult factory for details.

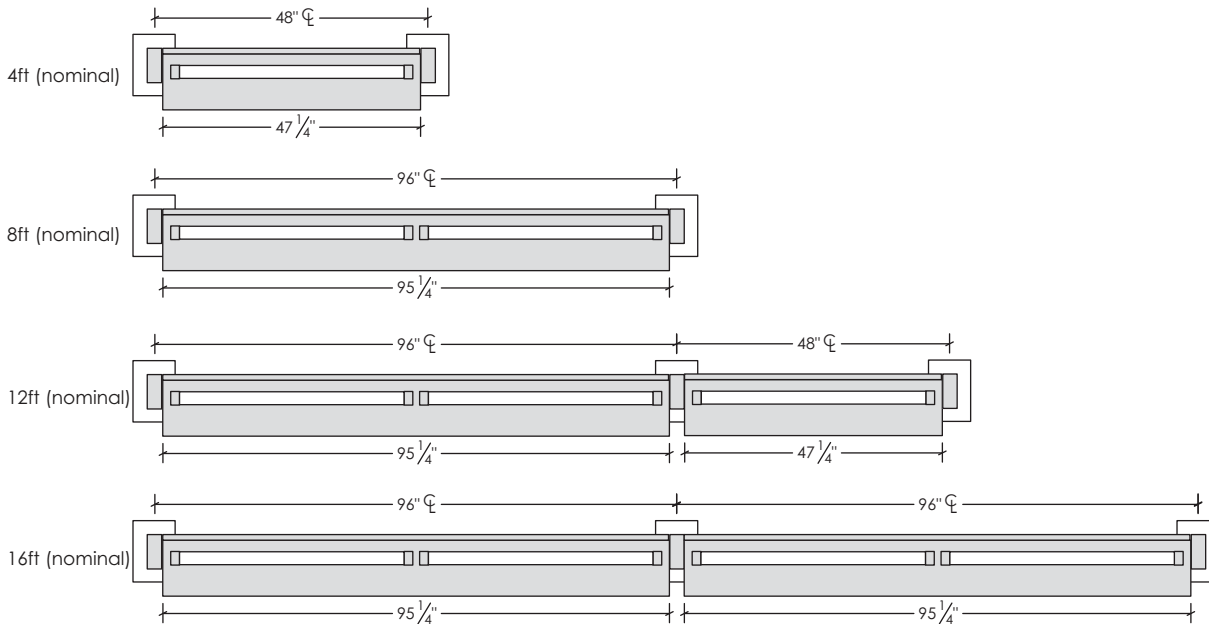

Staggered lamping not applicable.

Standard: Wall/Ceiling mount with integral 2" Junction box and canopy



JBOX2 - 2-1/4"W x 3-1/4"H canopy cover plate with factory supplied mini junction box.

Option: 4-1/2" Round Canopy

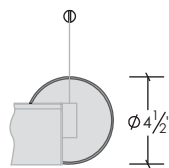

JBOX4 (4-1/2" round canopy). Junction box not included.

Option: Wall Tie-back



TIE-BACK - Aircraft cable wall tie-back. Required on extension over 36"

Option: Cable Suspension



ACSUSP - Aircraft cable suspension - unit will be non-rotatable.

TYPE:

Colors and Finishes:



STANDARD: "Ulti-matte" Natural aluminum : A two step, clear anodizing process that creates a smooth and durable surface.



OPTION: Black - BK powdercoat

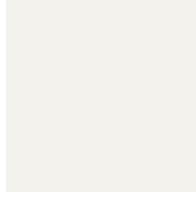

OPTION: White - WH powdercoat

RAL

OPTION: RAL - powdercoat the RAL color of your choice. Specify RAL code.

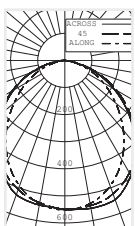

Efficiency

54.5 %

Catalog # CML-4-28

Design Specifications

Construction

Extruded architectural grade T6061 aluminum. Minimum wall thickness is .080" 100% recyclable.

Reflectors are formed from .040 aluminum and finished in Titanium white powdercoat.

Integral, 93.4% efficient, high-transmission optical lens for lamp shielding and superior diffusion.

Cast Aluminum end-caps, machined aluminum rotational fittings.

Electrical Details

All ballasts are electronic <10% THD

Class P electronic ballasts - Programmed start

Standard and dimming ballasts are integral to channel (unless otherwise noted).

LED options available (consult factory)

Multiple interface options available including dimming, motion sensing, daylight harvesting and DALI.

ETL listed for Indoor location only.

Emergency

Remote Emergency Ballast

Emergency one-lamp ballasts provide 90 minutes of illumination.

T5/T5HO = Initial output of 1300 Lumens

Finish

All fixtures are standard in Ultimatte aluminum finish (AL) - A deep etch and two-step clear anodizing process that gives a smooth, clean and durable surface.

Powder Coat options are available. Consult factory.



Architectural Lighting Works reserves the right to make changes to fixture design, finish and engineering at any time.

MILLENIUM STRETCH™

MLHA8 SERIES

PRODUCT FEATURES:

- » Surface mount – wall or ceiling; nominal 8"×24", 8"×36", 8"×48", 8"×72", 8"×96"
- » Individual luminaires
- » Peace of Mind Guarantee® against breakage
- » ADA compliant

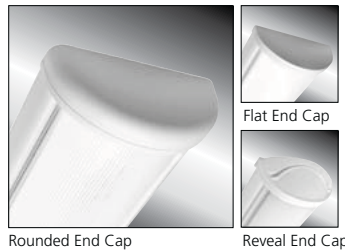

PROJECT INFORMATION

Job Name _____
Fixture Type _____
Catalog Number _____
Approved by _____

L-18

SPECIFICATIONS

HOUSING: Marine grade aluminum. Extruded body with die-cast end caps. Housing, with end caps, post assembly TGIC polyester powder coat finished – 5-step pre-treatment. See Ordering Information for standard, optional, architectural and custom finishes.

REFLECTOR: Full reflector/wire cover – 92% reflectivity.

LENS: UV-stabilized, high impact extruded clear or pearlescent polycarbonate. Smooth exterior, linear prismatic interior. Nominal thickness .156". Lens securely positioned in body channels and end caps. Lens locked in place with tamper-resistant stainless steel Torx® with center pin fasteners and sealed with closed cell gaskets.

END CAPS: Marine grade die-cast aluminum. Three styles available: Flat, Rounded and Reveal. Conduit and "Wiremold™" ready™ knockouts visible only from interior of end cap (Flat and Rounded styles only).

SOCKETS: Shock-resistant sockets with internal locking collar to ensure positive lamp retention.

HARDWARE: Stainless steel, tamper-resistant Torx fasteners secure lens in housing body's lens channel (four on 24", 36", and 48" housings; eight on 72" and 96" housings).

ELECTRICAL: **LED:** Replaceable high-brightness LED array in 4000K, 5000K and 5700K color temperatures. 120-277V AC high power factor constant current driver. 10-100% dimming with compatible 0-10V current-sink dimmer. Compatible with Kenall SmartSense™ control system. Class P ballasts. Fluorescent electronic 120/277/347 and dual voltage ballasts high power factor.

INSTALLATION: Standard four-point (24" housing), six-point (36" and 48" housing) and twelve-point (72" and 96" housing) mounting required for Peace of Mind Guarantee®.

PATENT: U.S. Patent Nos. 6,984,055 and 7,494,241.

PHOTOMETRICS: Photometry tested to the IESNA LM-79-08 standard by an ILAC/ISO17025 accredited laboratory. For additional photometric information, go to www.kenall.com.

WARRANTY: One (1) year warranty against defects in materials and workmanship. Five (5) year warranty on LED lamps and driver for defects resulting in a fixture lumen depreciation of 30% or greater.

LISTINGS: UL and CUL listed for Wet Location – covered ceiling mount. UL certified IP64 in compliance with IEC 60598 – ceiling mount. Corner, horizontal wall and pendant mount installation – damp location only. ADA compliant.



ORDERING INFORMATION (Ex: MLHA8-48-F-MB-CP-50L40K-DCC-DV-FS-9500)

Model	Length	End Cap	Finish	Lens	Lamp Qty	Lamp Type	Ballast/Driver Type	Circuit Qty	Voltage	Options	Accessories		
MLHA8													
Length		Lamp Type					Circuit Quantity (n/a with LED)			Accessories			
24	2'	2' Lengths					1	One	9500			Torx® Screwdriver	
36	3'	14 F14T5 (rapid start only)					2†	Two (2 Ballast minimum)	D-0552			Torx Driver Bit (Required for CMB Option)	
48	4'	17 F17T8					Voltage						
72	Two 3' (factory connected)	24▲ F24T5HO (rapid start only)					120	120 Volts	†			n/a on 2' T5/T5HO or 3' T5HO fixtures with EL, PEL or TN options	
96	Two 4' (factory connected)	3' Lengths					277	277 Volts	▲			n/a with 347V	
End Caps		21 F21T5 (rapid start only)					347	347 Volts (T8,T5HO)	▼			2' Fixtures have minimum 350-450 lumen battery pack	
F	Flat	25 F25T8					DV	120-277 Volts				■ n/a on 2' fixtures	
R	Rounded	39 F39T5HO (rapid start only)					Options			§			n/a with 3 lamps
RV	Reveal	4' Lengths					EL▲▼§			•			n/a with LED Lamp Options
50L40K	50 Watt 4000K LED (1/DCC/120-277V/-40°F)	50L50K					PEL▲■§						
50L57K	50 Watt 5700K LED (1/DCC/120-277V/-40°F)	100L40K					LEL						
100L40K	100 Watt 4000K LED (1/DCC/120-277V/-40°F)	100L50K					CDF						
100L50K	100 Watt 5000K LED (1/DCC/120-277V/-40°F)	100L57K					CMB						
100L57K	100 Watt 5700K LED (1/DCC/120-277V/-40°F)	28 F28T5 (rapid start only)					DL						
28	F28T5 (rapid start only)	32 F32T8					FS						
32	F32T8	54 F54T5HO (rapid start only)					NAT§						
54	F54T5HO (rapid start only)	54A F54T5HO amalgam (rapid start only)					NSF						
54A	F54T5HO amalgam (rapid start only)	Ballast/Driver Type					PH						
IS		Instant Start Electronic <10% THD (T8)					PM§						
RS		Rapid Start Electronic <10% THD (T8,T5,T5HO)					TN§						
SB		Specified Ballast					UC§						
DCC		Dimming Constant Current (LED)											



www.kenall.com

P: 800-4-Kenall

F: 847-360-1781

1020 Lakeside Drive Gurnee, Illinois 60031

When you see this image, you will know the Kenall product shown or described is designed and manufactured in the USA with components purchased from US suppliers, and meets the Buy American requirements under the ARRA. Kenall has not determined the origin of its domestically purchased components or the subcomponents thereof. Content of specification sheets is subject to change; please consult www.kenall.com for current product details. © 2013 Kenall Mfg. Co. All rights reserved.

MLHA8-111113

MILLENIUM STRETCH™

MLHA8 SERIES

DIMENSIONAL DATA

CROSS SECTION/DETAILS

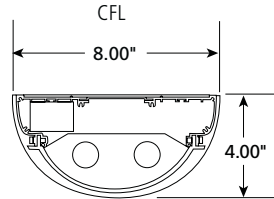
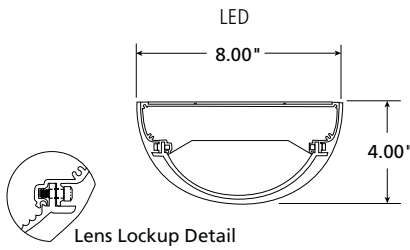

MOUNTING HOLES

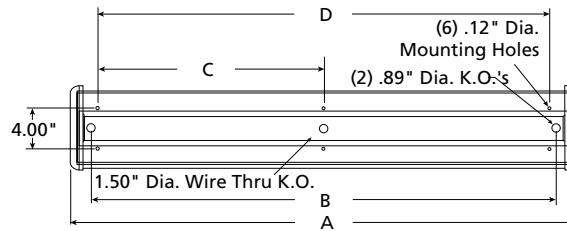

CORNER MOUNT BRACKET

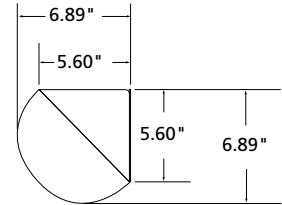

Nominal Two Foot Fixture Legend

LMP End Cap	A	B	C	D
T8 R	26.524	22.312	N/A	21.000
T8 F	25.308	22.312	N/A	21.000
T8 RV	28.632	22.312	N/A	21.000
T5 R	24.940	20.728	N/A	20.875
T5 F	23.724	20.728	N/A	20.875
T5 RV	27.048	20.728	N/A	20.875

Nominal Three Foot Fixture Legend

LMP End Cap	A	B	C	D
T8 R	38.524	34.312	16.500	33.000
T8 F	34.312	34.312	16.500	33.000
T8 RV	40.632	34.312	16.500	33.000
T5 R	36.751	32.540	16.344	32.688
T5 F	35.535	32.540	16.344	32.688
T5 RV	38.859	32.540	16.344	32.688

Nominal Four Foot Fixture Legend

LMP End Cap	A	B	C	D
T8/LED R	50.524	46.312	22.500	45.000
T8/LED F	49.308	46.312	22.500	45.000
T8/LED RV	52.632	46.312	22.500	45.000
T5 R	48.562	44.350	22.250	44.500
T5 F	47.346	44.350	22.250	44.500
T5 RV	50.670	44.350	22.250	44.500

www.kenall.com

P: 800-4-Kenall

F: 847-360-1781

1020 Lakeside Drive Gurnee, Illinois 60031

When you see this image, you will know the Kenall product shown or described is designed and manufactured in the USA with components purchased from US suppliers, and meets the Buy American requirements under the ARRA. Kenall has not determined the origin of its domestically purchased components or the subcomponents thereof. Content of specification sheets is subject to change; please consult www.kenall.com for current product details. © 2013 Kenall Mfg. Co. All rights reserved.

MLHA8-111113

Luminaire Type:
Catalog Number
(autopopulated):

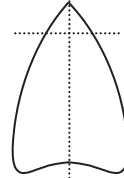

Gotham Architectural Downlighting
LED Downlights

4" Evo® Square Flangeless

Solid-State Lighting

FEATURES

OPTICAL SYSTEM

- Semi-specular, matte-diffuse lower reflector
- Patented Bounding Ray™ optical design (U.S. Patent No. 5,800,050)
- 55° cutoff to source and source image
- Top-down flash characteristic

MECHANICAL SYSTEM

- 16-gauge galvanized steel construction; maximum 1-1/4" ceiling thickness
- Telescopic mounting bars maximum of 24" and minimum of 15", preinstalled, 4" vertical adjustment
- Toolless adjustments post installation
- Junction box capacity: 8 (4 in, 4 out) 12AWG rated for 90°C
- Light engine and driver accessible through aperture

ELECTRICAL SYSTEM

- Fully serviceable and upgradeable LED light engine
- 70% lumen maintenance at 50,000 hours based on IESNA LM-79-2008
- 120-277VAC, 50/60hz power supply with 0-10V dimming (10-100%); rated for 50,000-hour life
- Overload and short circuit protected

LISTINGS

- Fixtures are CSA certified to meet US and Canadian standards; wet location, covered ceiling

WARRANTY

- 5-year limited warranty. Complete warranty terms located at: www.acuitybrands.com/CustomerResources/Terms_and_conditions.aspx

ORDERING INFORMATION

EXAMPLE: EVO SQ 35/10 4ARFL 120

Series	Type	Color temperature		Nominal lumen values		Aperture/Trim color		Trim style		Finish	Voltage	
EVO	SQ	27/	2700 K	06	600 lumens	4AR	Clear	FL	Flangeless	(blank)	Semi-specular	120
		30/	3000 K	10	1000 lumens	4PR	Pewter			LD	Matte diffuse	277
		35/	3500 K	14	1400 lumens	4WTR	Wheat					347
		41/	4100 K	18	1800 lumens	4WR ¹	White					
				20	2000 lumens	4BR ¹	Black					

Driver	Options
(blank)² 0-10V dimming driver. Minimum dimming level 10%	SF Single fuse
ECOS2³,⁵ Lutron® Hi-lume® 2-wire forward-phase dimming driver. Minimum dimming level 1%	RRL RELOC®-ready luminaire. Provides compatibility with Lithonia RELOC system. Access above ceiling required.
ECOS3²,³ Lutron® Hi-lume® 3-wire or EcoSystem® dimming driver. Minimum dimming level 1%	EL⁴ Emergency battery pack with integral test switch
	ELR⁴ Emergency battery pack with remote test switch
	CP⁶ Chicago plenum
	NEPP⁷ Interface for Sensor Switch® nLight® network with integral power supply. Refer to TN-623-01 .

ACCESSORIES order as separate catalog numbers (shipped separately)

ISD BC 0-10V wallbox dimmer. Refer to [ISD-BC](http://www.acuitybrands.com/ISD-BC).

NOTES

ORDERING NOTES

1. Not available with finishes.
2. Refer to [TECH-240](http://www.acuitybrands.com/TECH-240) for compatible dimmers.
3. Not available with NEPP option.
4. For dimensional changes, refer to [TECH-140](http://www.acuitybrands.com/TECH-140). Access above ceiling required.
5. 120V only
6. Not available with EL or ELR options.
7. Not available with 347V.

4" EVO SQUARE

Flangeless

Solid-State Lighting



DIMENSIONAL DATA

All dimensions are inches (centimeters) unless otherwise noted.

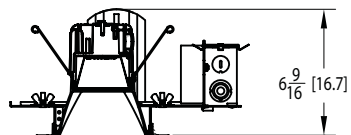
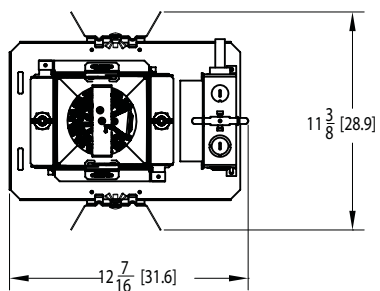

Aperture: 4-1/2 SQ [11.4]

Ceiling Opening: 5-1/4 SQ. [13.3]

Distribution Curve Distribution Data Output Data Coefficient of Utilization Illuminance: Single Luminaire 30" Above Floor

EVO-SQ 35/10 4AR 120

INPUT WATTS: 20.3, DELIVERED LUMENS: 1049.6, LM/W=51.7, 1.1 S/MH, TEST NO. LTL21901

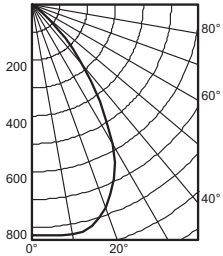

Ave	Lumens	Zone	Lumens	% Lamp	pf	80%			20%			50%		
						pc	30%	10%	50%	30%	10%	50%	30%	10%
0	829	0° - 30°	625.2	59.6	0	119	119	119	116	116	116	111	111	111
5	833	0° - 40°	888.0	84.6	1	110	107	105	108	106	103	104	102	100
15	825	0° - 60°	1049.2	100.0	2	102	97	94	100	96	93	97	93	91
25	692	0° - 90°	1049.6	100.0	3	94	88	84	92	88	84	90	86	82
35	423	90° - 180°	0.0	0.0	4	87	81	76	86	80	76	83	79	75
45	169	0° - 180°	1049.6	*100.0	5	81	74	69	80	74	69	78	72	69
55	25	*Efficiency			6	75	68	64	74	68	63	72	67	63
65	0				7	70	63	59	69	63	58	68	62	58
75	0				8	65	59	54	64	58	54	63	58	54
85	0				9	61	54	50	60	54	50	59	54	50
90	0				10	57	51	47	57	51	47	56	50	46

		50% beam - 57.3°		10% beam - 85.8°	
Initial FC					
Mounting Height	Center Beam	Diameter	FC	Diameter	FC
8.0	27.4	6.0	13.7	10.2	2.7
10.0	14.7	8.2	7.4	13.9	1.5
12.0	9.2	10.4	4.6	17.6	0.9
14.0	6.3	12.6	3.1	21.4	0.6
16.0	4.5	14.7	2.3	25.1	0.5

EVO-SQ 35/14 4AR 120

INPUT WATTS: 26.3, DELIVERED LUMENS: 1487.4, LM/W=56.6, 1.1 S/MH, TEST NO. LTL21925

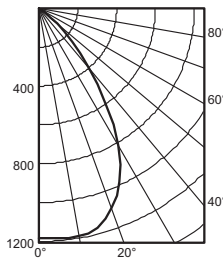

Ave	Lumens	Zone	Lumens	% Lamp	pf	80%			20%			50%		
						pc	30%	10%	50%	30%	10%	50%	30%	10%
0	1184	0° - 30°	886.2	59.6	0	119	119	119	116	116	116	111	111	111
5	1189	0° - 40°	1259.5	84.7	1	110	107	105	108	106	103	104	102	100
15	1167	0° - 60°	1487.0	100.0	2	102	97	94	100	96	93	97	93	91
25	982	0° - 90°	1487.4	100.0	3	94	89	84	92	88	84	90	86	82
35	601	90° - 180°	0.0	0.0	4	87	81	76	86	80	76	84	79	75
45	239	0° - 180°	1487.4	*100.0	5	81	74	70	80	74	69	78	73	69
55	34	*Efficiency			6	75	68	64	74	68	63	72	67	63
65	0				7	70	63	59	69	63	58	68	62	58
75	0				8	65	59	54	64	58	54	63	58	54
85	0				9	61	54	50	60	54	50	59	54	50
90	0				10	57	51	47	57	51	47	56	50	46

		50% beam - 56.9"		10% beam - 85.8"	
Initial FC					
Mounting Height	Center Beam	Diameter	FC	Diameter	FC
8.0	39.1	6.0	19.6	10.2	3.9
10.0	21.0	8.1	10.5	13.9	2.1
12.0	13.1	10.3	6.6	17.6	1.3
14.0	9.0	12.5	4.5	21.4	0.9
16.0	6.5	14.6	3.2	25.1	0.6

EVO-SQ 35/18 4AR 120

INPUT WATTS: 30.4, DELIVERED LUMENS: 1722.3, LM/W=56.7, 1.1 S/MH, TEST NO. LTL21899

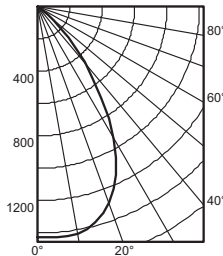

Ave	Lumens	Zone	Lumens	% Lamp	pf	80%			20%			50%		
						pc	30%	10%	50%	30%	10%	50%	30%	10%
0	1428	0° - 30°	1043.0	60.6	0	119	119	119	116	116	116	111	111	111
5	1430	0° - 40°	1469.8	85.3	1	110	108	105	108	106	104	104	102	100
15	1382	0° - 60°	1721.9	100.0	2	102	97	94	100	96	93	97	94	91
25	1147	0° - 90°	1722.3	100.0	3	94	89	85	93	88	84	90	86	82
35	686	90° - 180°	0.0	0.0	4	87	81	77	86	80	76	84	79	75
45	268	0° - 180°	1722.3	*100.0	5	81	75	70	80	74	70	78	73	69
55	34	*Efficiency			6	75	69	64	74	68	64	73	67	63
65	0				7	70	64	59	69	63	59	68	63	59
75	0				8	65	59	55	65	59	54	64	58	54
85	0				9	61	55	51	61	55	51	60	54	50
90	0				10	58	51	47	57	51	47	56	51	47

		50% beam - 55.9°		10% beam - 84.8°	
Initial FC					
Mounting Height	Center Beam	Diameter	FC	Diameter	FC
8.0	47.2	5.8	23.6	10.0	4.7
10.0	25.4	8.0	12.7	13.7	2.5
12.0	15.8	10.1	7.9	17.4	1.6
14.0	10.8	12.2	5.4	21.0	1.1
16.0	7.8	14.3	3.9	24.7	0.8

EVO-SQ 35/22 4AR 120

INPUT WATTS: 34.0, DELIVERED LUMENS: 1996.3, LM/W=58.7, 1.0 S/MH, TEST NO. LTL21897

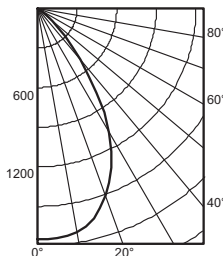

Ave	Lumens	Zone	Lumens	% Lamp	pf	80%			20%			50%		
						pc	30%	10%	50%	30%	10%	50%	30%	10%
0	1752	0° - 30°	1229.4	61.6	0	119	119	119	116	116	116	111	111	111
5	1748	0° - 40°	1716.3	86.0	1	110	108	105	108	106	104	104	102	100
15	1645	0° - 60°	1995.5	100.0	2	102	98	94	100	96	93	97	94	91
25	1330	0° - 90°	1996.3	100.0	3	94	89	85	93	88	84	90	86	83
35	781	90° - 180°	0.0	0.0	4	87	82	77	86	81	77	84	79	76
45	298	0° - 180°	1996.3	*100.0	5	81	75	70	80	74	70	78	73	69
55	36	*Efficiency			6	76	69	65	75	69	64	73	68	64
65	0				7	71	64	60	70	64	59	69	63	59
75	1				8	66	60	55	65	59	55	64	59	55
85	0				9	62	56	51	61	55	51	60	55	51
90	0				10	58	52	48	58	52	48	57	51	48

		50% beam - 54.1"		10% beam - 83.7"	
Initial FC					
Mounting Height	Center Beam	Diameter	FC	Diameter	FC
8.0	57.9	5.6	29.0	9.9	5.8
10.0	31.1	7.7	15.6	13.4	3.1
12.0	19.4	9.7	9.7	17.0	1.9
14.0	13.2	11.7	6.6	20.6	1.3
16.0	9.6	13.8	4.8	24.2	1.0

PHOTOMETRY NOTES

- Tested in accordance with IESNA LM-79-08.
- Tested to current IES and NEMA standards under stabilized laboratory conditions.
- Actual performance may differ as a result of end-user environment and application.
- Actual wattage may differ by +/- 10% when operating between 120-277V +/- 10%.
- CRI: 83 typical.
- Consult factory or IES file for microgroove baffle, black cone or other photometric reports.

VXLED26Y-3/4

Partial LED Vaporproof fixture requires RAB Globe and Guard. Can be used with color globes.

Color: Natural

Weight: 3.1 lbs

LED Info

Watts: 26W
 Color Temp: 3000K (Warm)
 Color Accuracy: 83
 L70 Lifespan: 100000
 LM79 Lumens: 0
 Efficacy: 0 LPW

Driver Info

Type: Constant Current
 120V: 0.25A
 208V: 0.14A
 240V: 0.13A
 277V: 0.11A
 Input Watts: 29W
 Efficiency: 90%

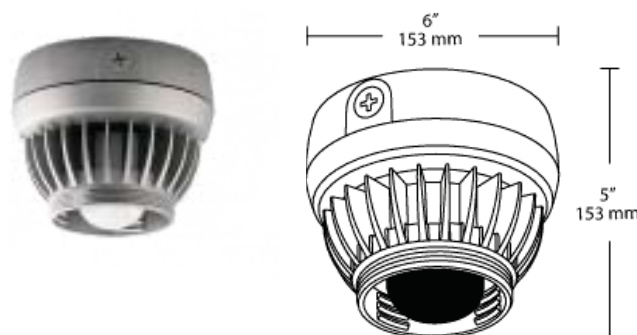

Technical Specifications

Lumen Maintenance:

100,000-hour LED lifespan based on IES LM-80 results and TM-21 calculations.

Specification:

These specifications are for fixture with Frosted Glass Globe and Die Cast Guard combination. Consult warehouse for different fixture combinations.

UL Listing:

Suitable for Wet locations only with outer globe and as a Downlight.

Globes and Guards:

Vaporproof LEDs are compatible with RAB Globes and Guards.

LED:

Multi-chip 26W high-output, long-life LED.

Driver:

Constant Current, 100V-277V, 50/60 Hz, 0.48 Amp, THD is less than or equal to 20% Power Factor 97.9%.

Fixture Efficacy:

49 Lumens per Watt

Color Accuracy:

83 CRI

Color Temperature:

3000K

Cold Weather Starting:

Minimum starting temperature is -40°F / -40°C.

Ambient Temperature:

Suitable for use in 40°C (104°F) ambient temps.

Thermal Management (Patent Pending):

Die-cast LED housing designed for maximum heat dissipation.

Housing:

All die-cast aluminum construction.

Gaskets:

High temperature silicone.

Finish:

Natural shot blasted aluminum.

Mounting:

(3) 3/4" NPS conduit entry points.

Color Consistency:

3-step MacAdam Ellipse binning to achieve consistent fixture-to-fixture color.

Color Stability:

LED color temperature is warranted to shift no more than 200K in CCT over a 5 year period.

Color Uniformity:

RAB's range of CCT (Correlated Color Temperature) follows the guidelines of the American National Standard for Specifications for the Chromaticity of Solid State Lighting (SSL) Products, ANSI C38.377-2011.

Green Technology:

RAB LEDs are Mercury and UV Free, and RoHS compliant.

IESNA LM-79 & LM-80 Testing:

RAB LED luminaires have been tested by an independent laboratory in accordance with IESNA LM-79 and LM-80, and have received the Department of Energy "Lighting Facts" label.



California Title 24:

LVAPOR complies with California Title 24 building and electrical codes.

Patents:

The design of the LVAPOR is protected by the following patents US D653,795; D651738 CN ZL201130028359.7; ZL201130028360.X, TW pat. pending MX 35699; pat. pending CA.

Country of Origin:

Designed by RAB in New Jersey and assembled in the USA by RAB's IBEW Local 3 workers.

Buy American Act Compliant:

This product is a COTS item manufactured in the United States, and is compliant with the Buy American Act.

Recovery Act (ARRA) Compliant:

This product complies with the 52.225-21 "Required Use of American Iron, Steel, and Manufactured Goods-- Buy American Act-- Construction Materials (October 2010).

Trade Agreements Act Compliant:

This product is a COTS item manufactured in the United States, and is compliant with the Trade Agreements Act.

GSA Schedule:

Suitable in accordance with FAR Subpart 25.4.

Warranty:

RAB warrants that our LED products will be free from defects in materials and workmanship for a period of five (5) years from the date of delivery to the end user, including coverage of light output, color stability, driver performance and fixture finish. See our full warranty .



GD200DGS

Die cast aluminum one piece guard with distinctive flat bottom for contemporary look. Machined threads for smooth fit. A headless set screw is provided to lock guard in place.

Color: Silver gray

Weight: 0.6 lbs

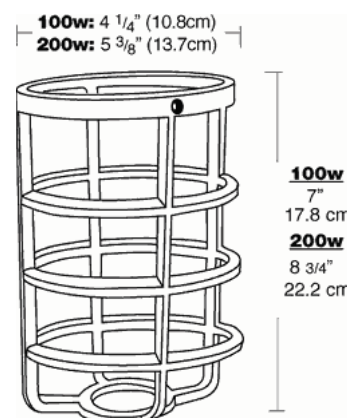

Technical Specifications

UL Listing:

Suitable for wet locations when used with RAB Vapor proof fixtures.

Die Cast Guards:

One pieced die cast aluminum. Set screw locks guard in place. Also a wire clamp guard is available.

Wire Clamp Guards:

No. 8 gauge steel wire rod welded to clamping band with captive clamping screw.

Patents:

RAB sensor and fixture designs are protected under U.S. and International Intellectual Property laws.

Country of Origin:

Designed by RAB in New Jersey and assembled in Taiwan.

Trade Agreements Act Compliant:

This product is a product of Taiwan and a "designated country" end product that complies with the Trade Agreements Act.



GSA Schedule:

Suitable in accordance with FAR Subpart 25.4.

GL100PRIS

Prismatic glass globes hide the light source and allow maximum light output in RAB and other standard size Vaporproof fixtures.

Color: Clear

Weight: 1.2 lbs

Technical Specifications

UL Listing:

Suitable for wet locations when used with Vaporproof fixtures. Suitable for dry, damp or wet locations when used as replacement globes for listed fixtures. Fixtures must be installed with lamp base up when outdoors.

Glass Globes:

Clear thermal shock resistant soda lime glass standard.

Maximum Wattage:

150 watts

Patents:

RAB sensor and fixture designs are protected under U.S. and International Intellectual Property laws.

Country of Origin:

Designed by RAB in New Jersey and assembled in the USA by RAB's IBEW Local 3 workers.

Buy American Act Compliant:

This product is a COTS item manufactured in the United States, and is compliant with the Buy American Act.

Recovery Act (ARRA) Compliant:

This product complies with the 52.225-21 "Required Use of American Iron, Steel, and Manufactured Goods-- Buy American Act-- Construction Materials (October 2010).

Trade Agreements Act Compliant:

This product is a COTS item manufactured in the United States, and is compliant with the Trade Agreements Act.

GSA Schedule:

Suitable in accordance with FAR Subpart 25.4.

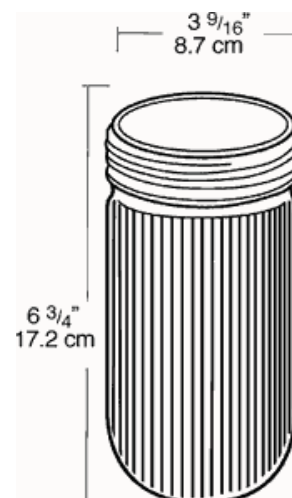

VXLED26Y-3/4

Partial LED Vaporproof fixture requires RAB Globe and Guard. Can be used with color globes.

Color: Natural

Weight: 3.1 lbs

LED Info

Watts: 26W
 Color Temp: 3000K (Warm)
 Color Accuracy: 83
 L70 Lifespan: 100000
 LM79 Lumens: 0
 Efficacy: 0 LPW

Driver Info

Type: Constant Current
 120V: 0.25A
 208V: 0.14A
 240V: 0.13A
 277V: 0.11A
 Input Watts: 29W
 Efficiency: 90%



Technical Specifications

Lumen Maintenance:

100,000-hour LED lifespan based on IES LM-80 results and TM-21 calculations.

Specification:

These specifications are for fixture with Frosted Glass Globe and Die Cast Guard combination. Consult warehouse for different fixture combinations.

UL Listing:

Suitable for Wet locations only with outer globe and as a Downlight.

Globes and Guards:

Vaporproof LEDs are compatible with RAB Globes and Guards.

LED:

Multi-chip 26W high-output, long-life LED.

Driver:

Constant Current, 100V-277V, 50/60 Hz, 0.48 Amp, THD is less than or equal to 20% Power Factor 97.9%.

Fixture Efficacy:

49 Lumens per Watt

Color Accuracy:

83 CRI

Color Temperature:

3000K

Cold Weather Starting:

Minimum starting temperature is -40°F / -40°C.

Ambient Temperature:

Suitable for use in 40°C (104°F) ambient temps.

Thermal Management (Patent Pending):

Die-cast LED housing designed for maximum heat dissipation.

Housing:

All die-cast aluminum construction.

Gaskets:

High temperature silicone.

Finish:

Natural shot blasted aluminum.

Mounting:

(3) 3/4" NPS conduit entry points.

Color Consistency:

3-step MacAdam Ellipse binning to achieve consistent fixture-to-fixture color.

Color Stability:

LED color temperature is warranted to shift no more than 200K in CCT over a 5 year period.

Color Uniformity:

RAB's range of CCT (Correlated Color Temperature) follows the guidelines of the American National Standard for Specifications for the Chromaticity of Solid State Lighting (SSL) Products, ANSI C38.377-2011.

Green Technology:

RAB LEDs are Mercury and UV Free, and RoHS compliant.

IESNA LM-79 & LM-80 Testing:

RAB LED luminaires have been tested by an independent laboratory in accordance with IESNA LM-79 and LM-80, and have received the Department of Energy "Lighting Facts" label.



California Title 24:

LVAPOR complies with California Title 24 building and electrical codes.

Patents:

The design of the LVAPOR is protected by the following patents US D653,795; D651738 CN ZL201130028359.7; ZL201130028360.X, TW pat. pending MX 35699; pat. pending CA.

Country of Origin:

Designed by RAB in New Jersey and assembled in the USA by RAB's IBEW Local 3 workers.

Buy American Act Compliant:

This product is a COTS item manufactured in the United States, and is compliant with the Buy American Act.

Recovery Act (ARRA) Compliant:

This product complies with the 52.225-21 "Required Use of American Iron, Steel, and Manufactured Goods-- Buy American Act-- Construction Materials (October 2010).

Trade Agreements Act Compliant:

This product is a COTS item manufactured in the United States, and is compliant with the Trade Agreements Act.

GSA Schedule:

Suitable in accordance with FAR Subpart 25.4.

Warranty:

RAB warrants that our LED products will be free from defects in materials and workmanship for a period of five (5) years from the date of delivery to the end user, including coverage of light output, color stability, driver performance and fixture finish. See our full warranty .



GL100W

Threaded glass globes fit RAB and other standard Vaporproof fixtures and Lawn Lights

Color: White

Weight: 1.3 lbs

Technical Specifications

UL Listing:

Suitable for wet locations when used with Vaporproof fixtures. Suitable for dry, damp or wet locations when used as replacement globes for listed fixtures. Fixtures must be installed with lamp base up when outdoors.

Glass Globes:

Clear thermal shock resistant soda lime glass standard.

Maximum Wattage:

100 watts.

Patents:

RAB sensor and fixture designs are protected under U.S. and International Intellectual Property laws.

Country of Origin:

Designed by RAB in New Jersey and assembled in the USA by RAB's IBEW Local 3 workers.

Buy American Act Compliant:

This product is a COTS item manufactured in the United States, and is compliant with the Buy American Act.

Recovery Act (ARRA) Compliant:

This product complies with the 52.225-21 "Required Use of American Iron, Steel, and Manufactured Goods-- Buy American Act-- Construction Materials (October 2010).

Trade Agreements Act Compliant:

This product is a COTS item manufactured in the United States, and is compliant with the Trade Agreements Act.

GSA Schedule:

Suitable in accordance with FAR Subpart 25.4.



VXLED13Y

Partial LED Vaporproof fixture requires RAB Globe and Guard. Can be used with color globes.

Color: Natural

S-3

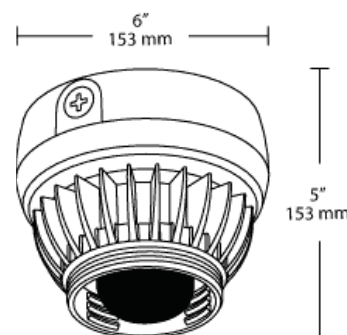

LED Info

Watts: 13W
Color Temp: 3000K (Warm)
Color Accuracy: 86
L70 Lifespan: 100000
LM79 Lumens: 0
Efficacy: 0 LPW

Driver Info

Type: Constant Current
120V: 0.13A
208V: 0.08A
240V: 0.07A
277V: 0.06A
Input Watts: 15W
Efficiency: 86%

Technical Specifications

Lumen Maintenance:

100,000-hour LED lifespan based on IES LM-80 results and TM-21 calculations.

Specification:

These specifications are for fixture with Frosted Glass Globe and Die Cast Guard combination. Consult warehouse for different fixture combinations.

UL Listing:

Suitable for Wet locations only with outer globe and as a Downlight.

Fixture Efficacy:

48 Lumens per Watt

Globes and Guards:

Vaporproof LEDs are compatible with RAB Globes and Guards.

Color Accuracy:

65 CRI

Light Color (Nominal CCT):

3000K

Driver:

Multi-chip single 13W high output long life LED Driver. Constant Current, 100V-277V, 50/60 Hz., 100-240VAC .3-.15 Amps 277VAC .15 Amps. Will deliver 70% of its initial lumens at 100,000 hours based on LM-80 Tests.

Construction:

Die cast aluminum housing and door. Tether connects back housing halves for safety.

Thermal Management (Patent Pending):

Die cast aluminum LED housing designed for maximum heat dissipation.

Surge Protection:

4KV

Housing:

Die cast aluminum housing and driver housing.

Mounting:

Three 1/2" NPS conduit entry points.

Reflector:

High quality hydroformed semi-specular aluminum.

Gaskets:

High Temperature Silicone.

Finish:

Natural shot blasted aluminum.

Green Technology:

Mercury and UV free.

IESNA LM-79 & IESNA LM-80 Testing:

RAB LED luminaires have been tested by an independent laboratory in accordance with IESNA LM-79 and 80, and have received the Department of Energy "Lighting Facts" label.

Color Consistency:

3-step MacAdam Ellipse binning to achieve consistent fixture-to-fixture color.

Color Stability:

LED color temperature is warrantied to shift no more than 200K in CCT over a 5 year period.

Color Uniformity:

RAB's range of CCT (Correlated color temperature) follows the guidelines of the American National Standard for Specifications for the Chromaticity of Solid State Lighting (SSL) Products, ANSI C38.377-2011.



Warranty:

RAB warrants that our LED products will be free from defects in materials and workmanship for a period of five (5) years from the date of delivery to the end user, including coverage of light output, color stability, driver performance and fixture finish. See our full warranty .

Patents:

The VXLED design is protected by Taiwan Patent 01510952 and patents pending in the U.S., Canada, China and Mexico.

Country of Origin:

Designed by RAB in New Jersey and assembled in Taiwan.

Trade Agreements Act Compliant:

This product is a product of Taiwan and a "designated country" end product that complies with the Trade Agreements Act.

GSA Schedule:

Suitable in accordance with FAR Subpart 25.4.

GL200R

Threaded glass globes fit RAB and other standard Vaporproof fixtures and Lawn Lights

S-3

Color: Ruby

Weight: 2.4 lbs

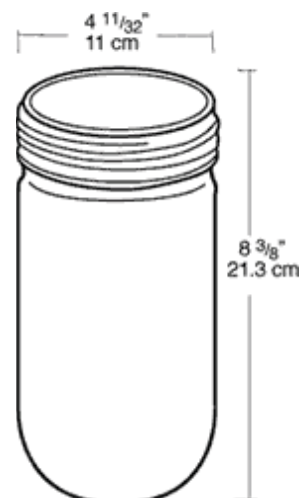

Technical Specifications

UL Listing:

Suitable for wet locations when used with Vaporproof fixtures. Suitable for dry, damp or wet locations when used as replacement globes for listed fixtures. Fixtures must be installed with lamp base up when outdoors.

Glass Globes:

Clear thermal shock resistant soda lime glass standard.

Maximum Wattage:

200 watts.

Patents:

RAB sensor and fixture designs are protected under U.S. and International Intellectual Property laws.

Country of Origin:

Designed by RAB in New Jersey and assembled in the USA by RAB's IBEW Local 3 workers.

Buy American Act Compliant:

This product is a COTS item manufactured in the United States, and is compliant with the Buy American Act.

Recovery Act (ARRA) Compliant:

This product complies with the 52.225-21 "Required Use of American Iron, Steel, and Manufactured Goods-- Buy American Act-- Construction Materials (October 2010).

Trade Agreements Act Compliant:

This product is a COTS item manufactured in the United States, and is compliant with the Trade Agreements Act.

GSA Schedule:

Suitable in accordance with FAR Subpart 25.4.



FEATURES & SPECIFICATIONS

INTENDED USE — Ideal for applications requiring attractive, quick installation exit signs and low energy consumption.

CONSTRUCTION — Engineering-grade thermoplastic housing is impact-resistant, scratch-resistant and corrosion-proof. UL94V-0 flame rating. UV-stable resin resists discoloration from natural and man-made light sources.

Rugged unibody housing snaps together with no additional mechanical fasteners. Faceplate and back cover are interchangeable on housing. Positive snap-fit tabs hold faceplate securely, yet are easily removed for lamp compartment access.

Universal directional chevron inserts are easily removed and reinserted. Uniform illumination without shadows or hot spots. Reinforced, impact-resistant color panels. Letters 6" high with 3/4" stroke, with 100 ft. viewing distance rating, based upon UL924 standards.

U.S. Patent No. 5,526,251; 5,611,163; 5,954,423; 5,988,825; 6,152,581; 6,502,044; D383,501 and D495,751. Other patents pending.

OPTICS — LEDs mounted on printed circuit boards. The typical life of the exit LED lamp is 10 years. Low energy consumption — less than one watt.

INSTALLATION — Universal (top, end or back) mounting. Easily removed mounting knockouts. J-box pattern on back panel. Housing snaps to canopy with four positive-locking tabs. Cam-locking pin tightly secures housing to canopy.

LISTINGS — UL damp location listed 50°-104°F (10°-40°C) standard. NOM Certified (see Options). Meets UL924, NFPA 101 (current Life Safety Code), NEC and OSHA illumination standards. NEMA Premium certified.

WARRANTY — Five-year limited warranty, including the LED lamps.

Complete warranty terms located at:

www.acuitybrands.com/CustomerResources/Terms_and_conditions.aspx

All life safety equipment, including emergency lighting for path of egress must be maintained, serviced, and tested in accordance with all National Fire Protection Association (NFPA) and local codes. Failure to perform the required maintenance, service, or testing could jeopardize the safety of occupants and will void all warranties.

Actual performance may differ as a result of end-user environment and application.

Note: Specifications subject to change without notice.

Catalog Number
Notes
Type



QUANTUM®
Thermoplastic Exits

LQM

LED LAMPS



NEMA Premium

Specifications

Length: 11-3/4 (29.8)

Depth: 2 (5.1)

Height: 7-5/8 (19.3)

Weight: 2.6 lbs (1.2 kgs)

All dimensions are inches (centimeters) unless otherwise specified.

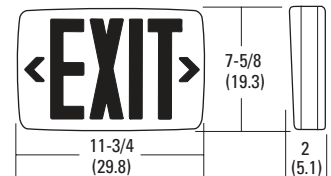

ORDERING INFORMATION

For shortest lead times, configure product using **standard options (shown in bold)**.

Example: LQM S W 3 R 120/277

LQM			3		120/277	
Family	Face type	Housing color	Number of faces	Letter color	Input voltage	Options
LQM	S Stencil P Panel ¹	(blank) Black W White	3 Single face with extra faceplate and color	R Red G Green	120/277 Dual voltage	(blank) None X2 Primary and secondary AC inputs provided NOM NOM certified for Mexico ²

Accessories: Order as separate item.³

ELA WG1	Back-mount wireguard
ELA WGEXT	Top-mount wireguard
ELA WGEXE	End-mount wireguard
ELA LQMUS12	12" Stem Kit ⁴

Notes

- Only available in custom signage. See spec sheet, [Custom Signage](#).
- Available with Stencil or Panel faces in white housing and red letters only.
- See spec sheet [ELA-WG](#).
- See spec sheet [ELA-Stemkits](#).

SPECIFICATIONS

ELECTRICAL				
Primary Circuit				
Type	Typical LED life¹	Supply voltage	Input watts	Max. amps
Red LED	10 years	120	.62	.05
		277	.69	.06
Green LED	10 years	120	.62	.05
		277	.74	.06

Notes

1 Based on continuous operation. The typical life of the exit LED lamp is 10 years.

MOUNTING

All dimensions are inches (centimeters) unless otherwise specified.
Shipping weight: 2.6 lbs. (1.2 kgs.)

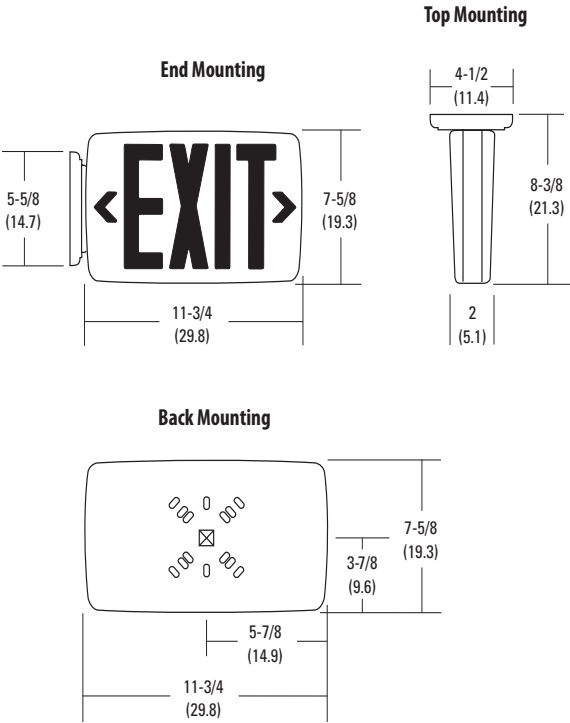

KEY FEATURES

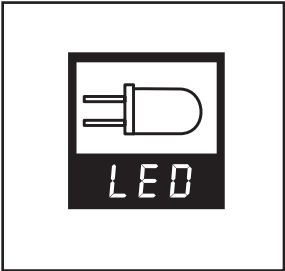

The typical life of the exit LED lamp is 10 years.