

PATTERN:
OUTDOOR CONNECTIONS
SOUTH TOWARD SRC
EAST

How TO USE DARK AREAS?
COZY AND DARK
AND SOFT

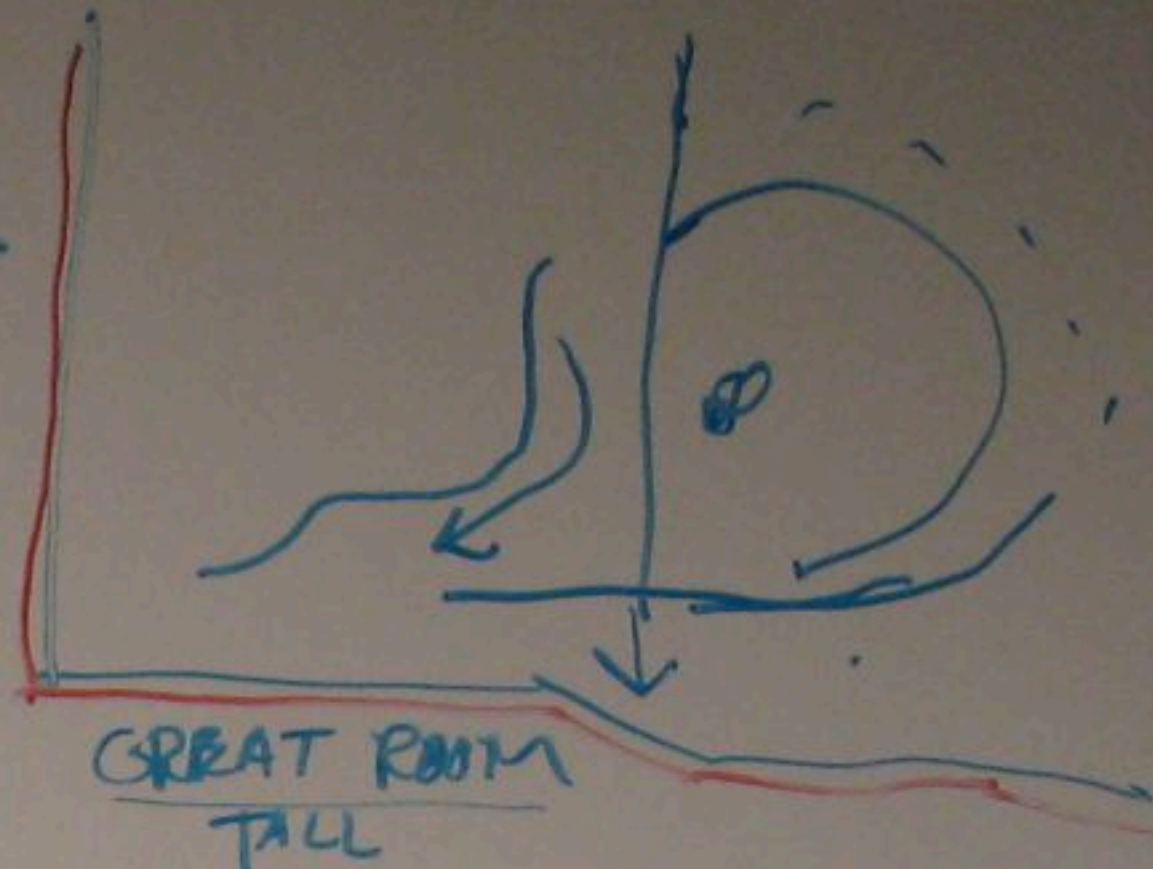
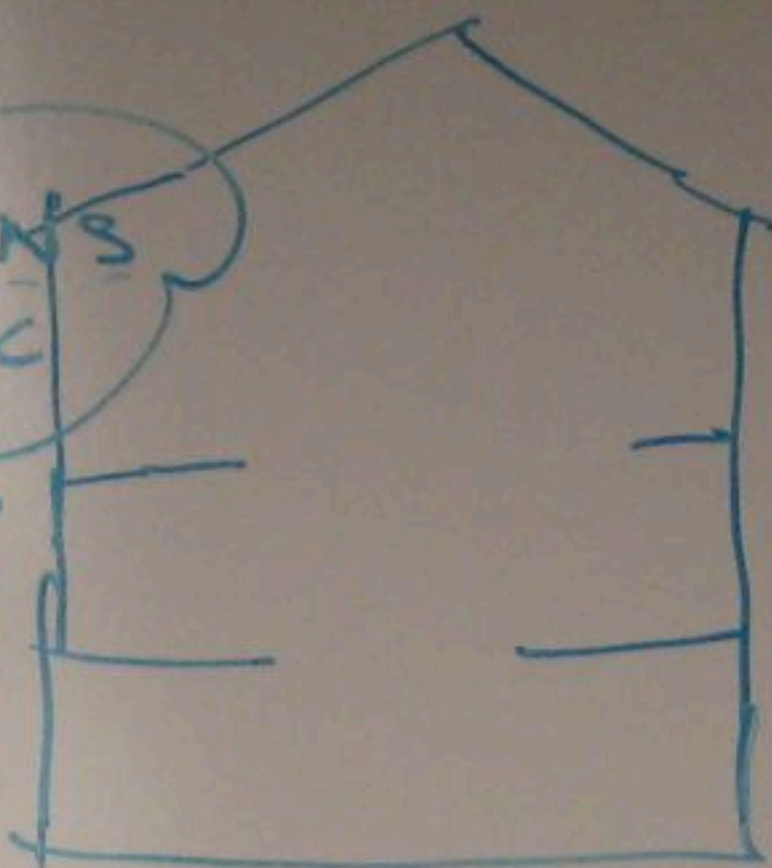

GREAT ROOM
TALL

MULTIPLE USES
INTERACTIVE

VISIBLE FOOD PREP
OR AT LEAST
FOOD PROXIMITY

WILLAMETTE ATRIUM. ^{BOLD} BUT COULD

LIKE FISHBOWL IF CENTRAL

HEART OF THE HEART
HUB OF THE HUB

WIEDEN & KENNEDY
INDOR COMPLIMENT TO
AMPHITHEATRE

SUNKEN CENTRAL ELEMENT AT UNC

FISHBOWL

CURVED IN A RECTILINEAR
BLDG.

"O"

SEE - BE SEEN

ICONIC - ANIMAL HOUSE

SOUTH & EAST POTENTIAL
FOR CONNECTIONS

HOW MUCH TO PRESERVE
EAST LAWN?

How TO BRING LIGHT
DEEPER INTO BUILDING?

24/7 PATTERN &
SECURITY LAYERS
WELCOMING - VISIBLE - BEACON

EMU TELLS STORIES OF VO

TECHNOLOGY & DIGITAL CULTURE
INTERSECTION OF PUBLIC WITH ART & CULTURE

DEB

HELEN

NATURAL BOUNDARIES

SOUTH EDGE OF SOUTH PARKING LOT
N. S. WALK WEST OF CARSON

CAMPUS PLAN POLICY →

SMARTLY SAY WHO WE ARE - DIFFERENTIATES

Jiopia

Lillis : brick + glass
: atrium

Knight Law

HEDCO / College of Education

Allen Hall

Student Rec. Ctr : glass, windows

[Riverbank public space

Scale / character of 13th Kincaid University.
(diagram structure)

breakdown scale
incorporation of trees

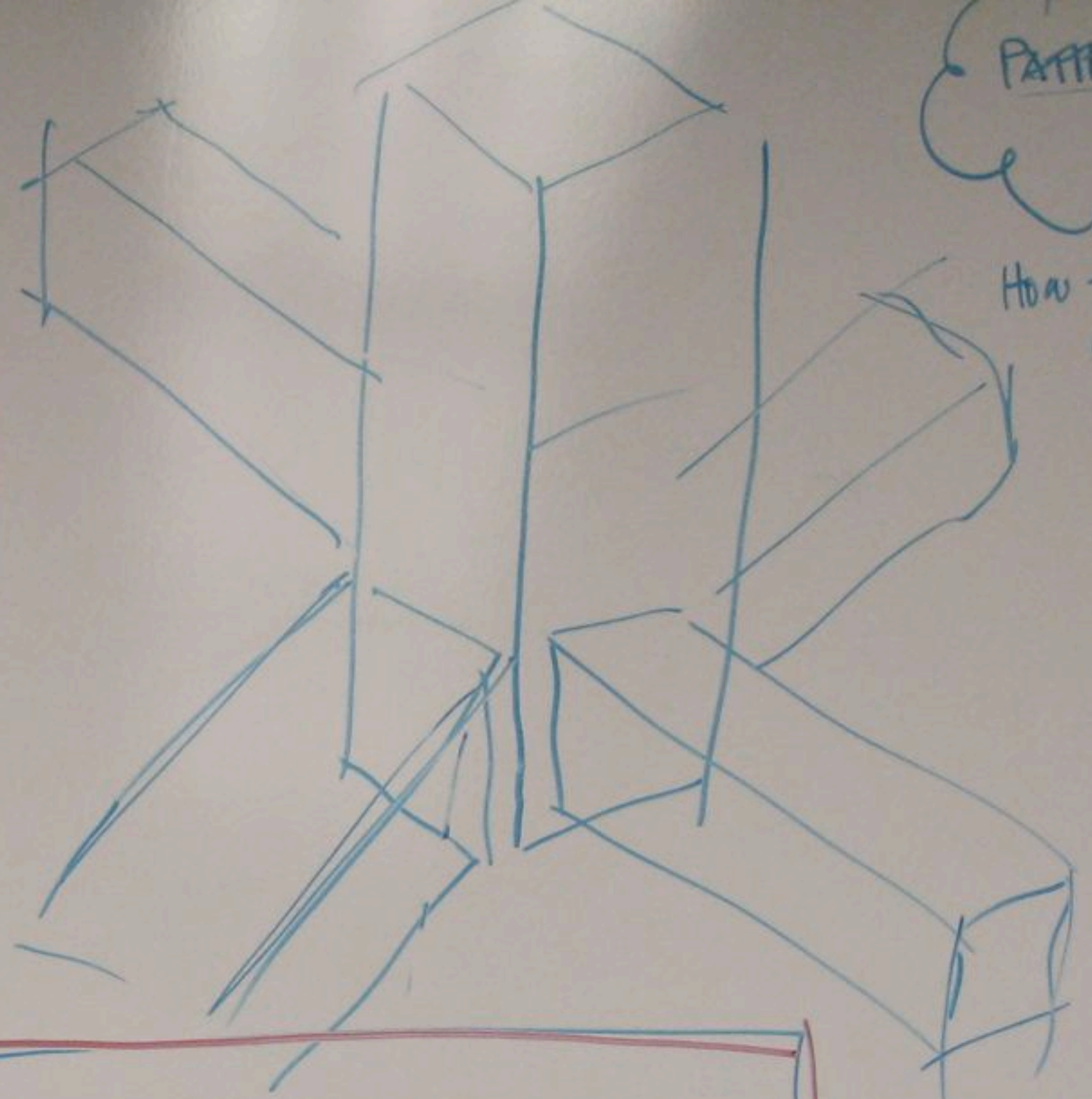

Essay :

- fit
- solutions
- future-oriented
- flexible thinking
- ~~shippable~~
- historic fabric
- complicated existing conditions
- ability to be practical
- deep understanding of role of technology
- has embraced and adapted aspects of design
- example for sustainability